

After '93:

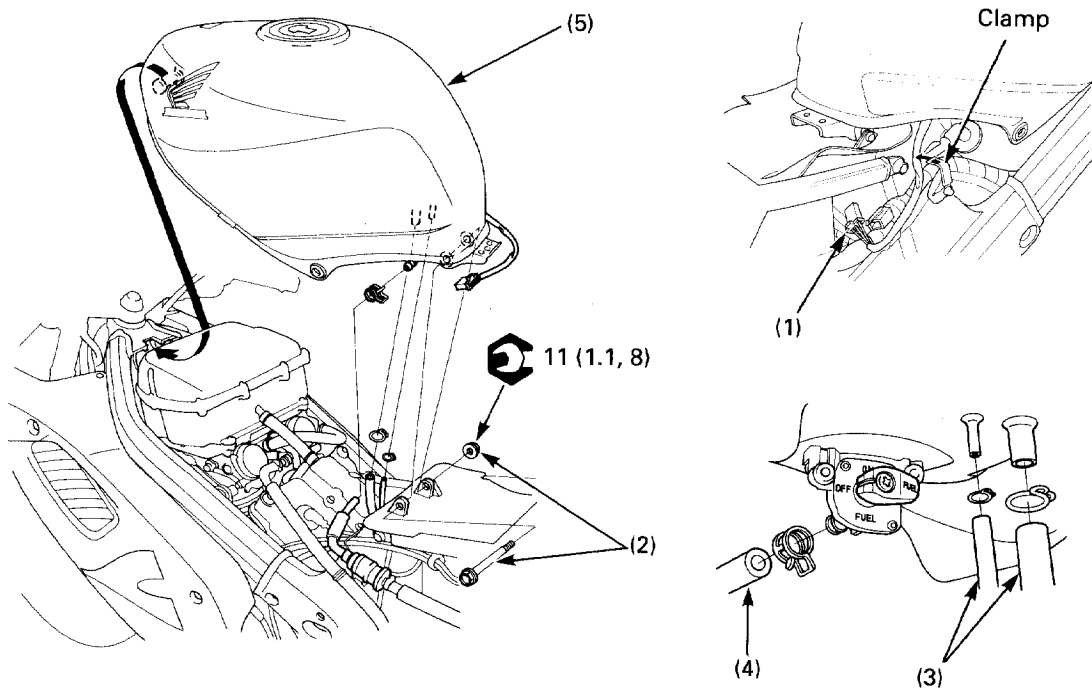

**WARNING**

- Gasoline is extremely flammable and is explosive under certain conditions. KEEP OUT OF REACH OF CHILDREN.
- Work in a well-ventilated area. Smoking or allowing flames or sparks in the work area or where gasoline is stored can cause a fire or explosion.

**NOTE**

- Before removal, turn the fuel valve OFF.
- After installation, check the fuel line for leakage.

**Requisite Service**

- Rear fairing removal/installation (page 2-3)

Procedure	Q'ty	Remarks
<b>Removal Order</b>		
(1) Fuel level sensor connector	1	Installation is in the reverse order of removal. Release the level sensor wire from the clamp.  Raise the rear of the fuel tank by supporting the front mounting portion of the tank and disconnect the tubes. Slide the fuel tank rearward and remove it. <b>NOTE</b> • Do not damage the tank mounting grommets when installing the tank.
(2) Bolt/nut	1/1	
(3) Drain/breather tube (California: No.1 tube)	1/1	
(4) Fuel tube	1	
(5) Fuel tank	1	