

Upper Fairing

'90-'93:

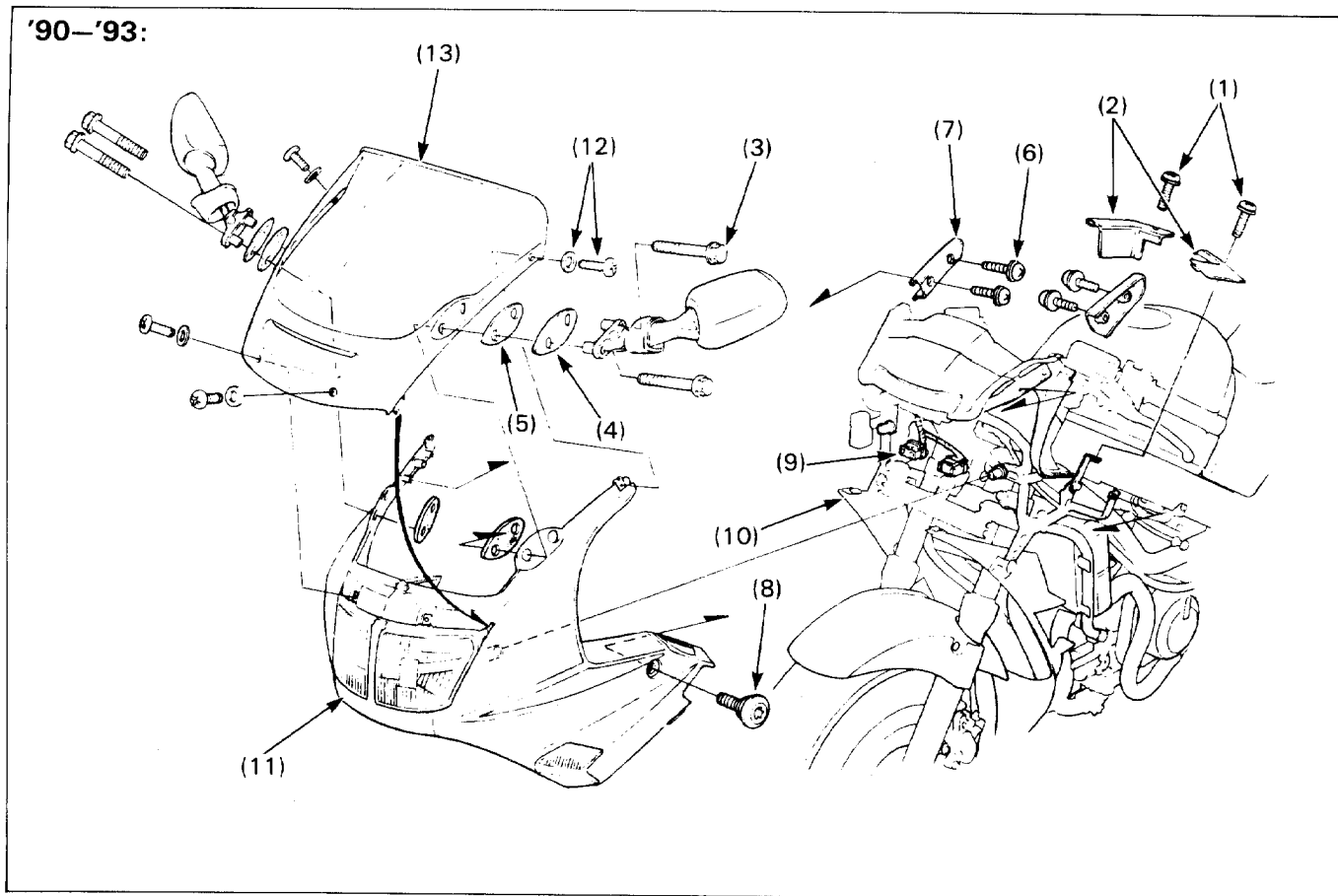

Requisite Service

- Remove the middle fairing (page 2-4).
- Support the motorcycle by placing a support block under the engine.

Procedure	Q'ty	Remarks
Removal Order		• Installation is in the reverse order of removal.
(1) Fairing inner cover screw	2	
(2) Fairing inner cover	1	
(3) Rear view mirror bolt	4	
(4) Plate	2	
(5) Rubber	2	
(6) Socket bolt	4	
(7) Inner cover	2	
(8) Upper fairing socket bolt	2	
(9) Headlight connector	1	
(10) Front turn signal connector	2	
(11) Upper fairing	1	
(12) Windshield screw washer	1/1	
(13) Windshield	1	