

Crankcase Separation

Screw the case puller shaft onto the crankshaft end.
 Attach the case puller by threading the bolts into the bolt holes of the stator.
 Separate the crankcase by turning the case puller shaft clockwise.

- S. TOOL**
- | | |
|-----------------|------------------------|
| Case puller | 07935 - GK80000 |
| Shaft protector | 07931 - 1870000 |

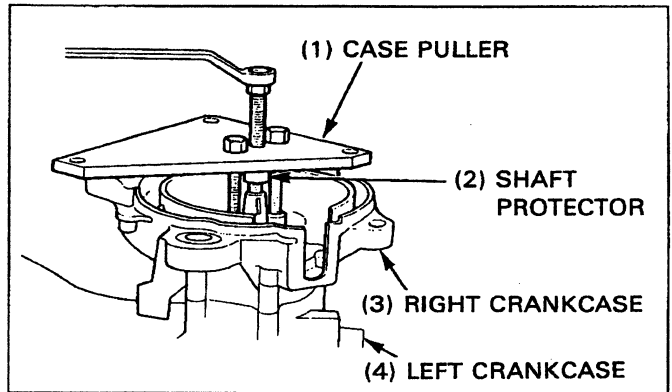

Crankshaft Removal

Attach the case/driven gear puller on the left crankcase as shown, and remove the crankshaft by turning the puller shaft clockwise.

- S. TOOL**
- | | |
|-------------------------|------------------------|
| Case/driven gear puller | 07935 - KG80000 |
| Shaft protector | 07931 - 1870000 |

NOTE

- Do not remove the crankshaft by tapping it.

Remove the right and left oil seals from the crankcases.
 Remove the right and left bearings from the crankcases.

When the bearing stays on the crankshaft, remove it with the universal bearing puller.

- S. TOOL**
- | | |
|--------------------------|------------------------|
| Universal bearing puller | 07631 - 0010000 |
| Shaft protector | 07931 - 1870000 |

NOTE

- Replace the crankshaft bearings and oil seals with new ones when the crankcase is separated.

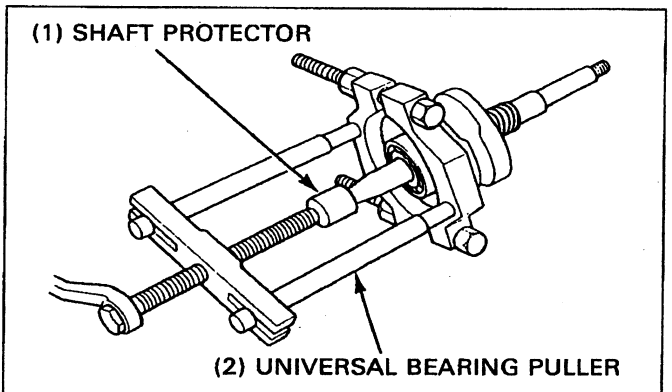
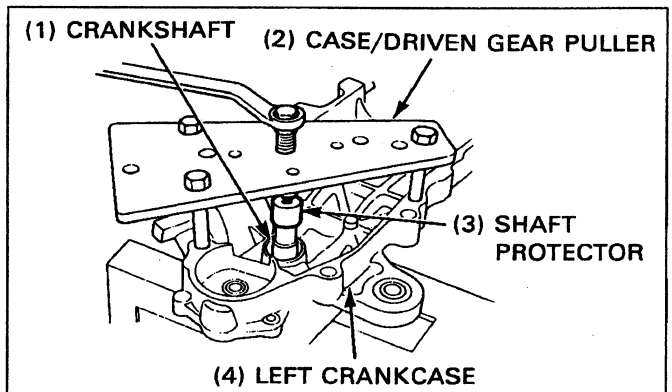

Crankshaft Installation

Wash the crankcase in solvent and blow dry with compressed air.
 Check the crankcases for cracks or other faults.

Apply clean 2-stroke engine oil to all moving and sliding surfaces.

Remove all gasket material from the crankcase mating surfaces.

Dress any roughness or irregularities with an oil stone.