

F-12

FRONT COWL

F14

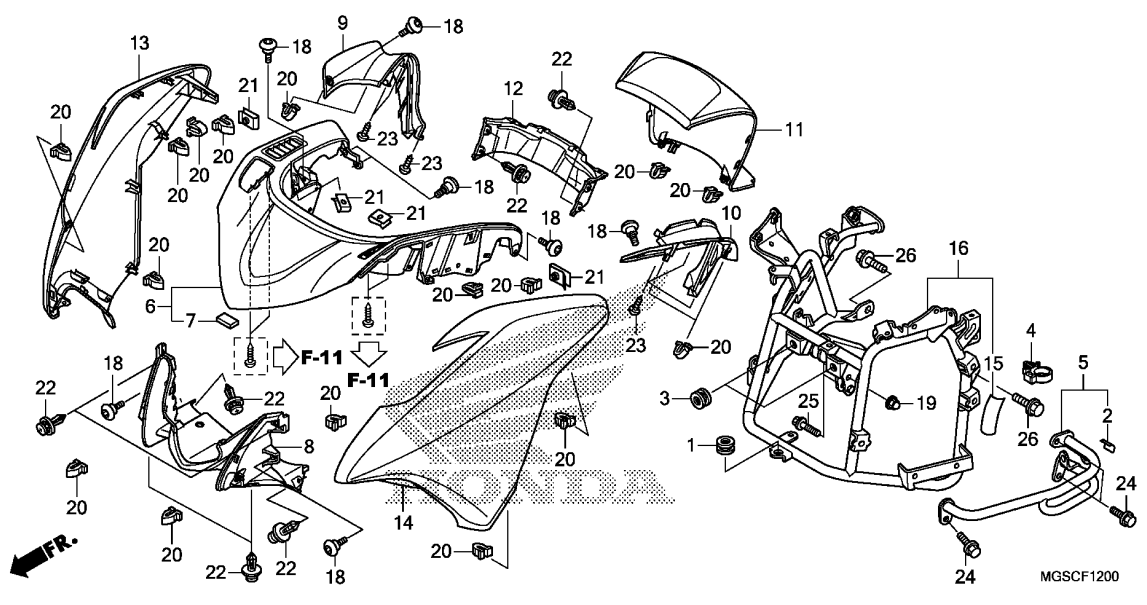

Ref. No.	L.O.N.	(Relative ref. Number) Description	F.R.T.
5	4101G6	GUARD, FRONT	0.5
6	4111U6	COVER, GARNISH	1.0
8	4111S7	COVER, AIR INTAKE	0.5
11		(9,10)	
	411142	COWL, INNER :CENTER	0.2
12	4131ES	COVER, FRONT INNER :CENTER ...	0.2
13	4111L5	COWL, FRONT :RIGHT	0.3
14	4111L4	COWL, FRONT :LEFT	0.3
	4111L6	COWL, FRONT :BOTH	0.4
16	4111O5	STAY, FRONT COVER	2.5

Ref. No.	Part No.	Description	Reqd. QTY	Serial No.	Parts catalogue code
			NC700D C		
1	17245-107-010	RUBBER, AIR CLEANER CASE MOUNTING	1		
2	17528-MFY-A00	TAPE, FUEL TANK(25X25)	1		
3	18316-KFT-620	RUBBER, PROTECTOR	2		
4	53781-SEO-952	CLIP, RETURN HOSE	1		
5	57150-MGS-D70	GUARD, ABS MODULATOR	1		
6	64110-MGS-D70ZA	GARNISH COMP., FR. *R256R*.....BURGUNDY RED	1	-----	2ED,2F,3E,E,ED,F,KO,TH
	64110-MGS-D70ZB	*NH1*.....BLACK	1		
7	64111-MGS-D70	MAT A, GARNISH	1		
8	64120-MGS-D70	COVER, AIR INTAKE	1		
9	64130-MGS-D70ZA	COVER, R. INNER *R256R*.....BURGUNDY RED	1	-----	2ED,2F,3E,E,ED,F,KO,TH
	64130-MGS-D70ZB	*NH1*.....BLACK	1		
10	64140-MGS-D70ZA	COVER, L. INNER *R256R*.....BURGUNDY RED	1	-----	2ED,2F,3E,E,ED,F,KO,TH
	64140-MGS-D70ZB	*NH1*.....BLACK	1		
11	64150-MGS-D70ZA	COVER COMP., INNER(WL) *NH1*.....BLACK	1		
12	64160-MGS-D70	COVER, INNER CENTER	1		
13	64310-MGS-D70ZC	COWL, R. FR. SIDE *NHA66P*..PEARL SUNBEAM WHITE	1	-----	2ED,2F,3E,E,ED,F,KO,TH
	64310-MGS-D70ZD	*NHA64P*..PEARL COSMIC BLACK	1	-----	2ED,2F,3E,E,ED,F,KO,TH
	64310-MGS-D70ZA	*R151CU*.CANDY GRACEFUL RED-U	1	-----	2ED,2F,3E,E,ED,F,TH
	64310-MGS-D70ZB	*PB388M*..ION BLUE METALLIC	1	-----	2ED,2F,3E,E,ED,F,TH,U
14	64360-MGS-D70ZC	COWL, L. FR. SIDE *NHA66P*..PEARL SUNBEAM WHITE	1	-----	2ED,2F,3E,E,ED,F,KO,TH

