

F-12

FRONT COVER/METER VISOR

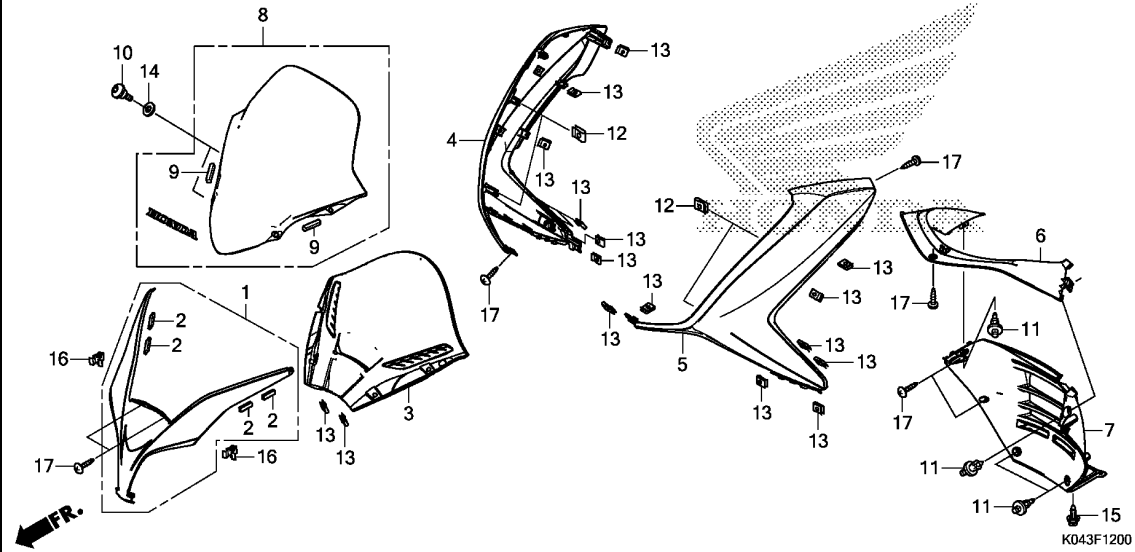

Ref. No.	L.O.N.	(Relative ref. Number) Description	F.R.T.
1	4111M3	GARNISH, WINDSCREEN .....	0.2
4	4111U8	COVER, FRONT :RIGHT .....	0.8
5	4111U7	COVER, FRONT :LEFT .....	0.8
	4111U9	COVER, FRONT :BOTH .....	0.8
6	413122	COVER, FRONT CENTER .....	0.1
7	413130	COVER, FRONT LOWER .....	0.2
8		(3)	
	411115	WINDSCREEN SET .....	0.2

Ref. No.	Part No.	Description	Reqd. QTY		Serial No.	Parts catalogue code
			NSS 300 D	NSS 300A D		
1	64300-K04-930ZF	GARNISH SET, SCREEN *NHA14M*.SEAL SILVER METALLIC	1	1	-----	E,ED,F,KO
	64300-K04-930ZB	*NHA87P*PEARL HIMALAYAS WHITE	1	1		
	64300-K04-930ZD	*NHA35M* ASTEROID BLACK METALLIC	1	1		
2	64306-K04-930	RUBBER, GARNISH .....	4	4		
3	64336-K04-930	PANEL, FR. METER .....	1	1		
4	64501-K04-930ZD	COVER, R. FR. SIDE *NHA14M*.SEAL SILVER METALLIC	1	1	-----	E,ED,F,KO
	64501-K04-930ZB	*NHA87P*PEARL HIMALAYAS WHITE	1	1		
	64501-K04-930ZC	*NHA35M* ASTEROID BLACK METALLIC	1	1		
5	64502-K04-930ZD	COVER, L. FR. SIDE *NHA14M*.SEAL SILVER METALLIC	1	1	-----	E,ED,F,KO
	64502-K04-930ZB	*NHA87P*PEARL HIMALAYAS WHITE	1	1		
	64502-K04-930ZC	*NHA35M* ASTEROID BLACK METALLIC	1	1		
6	64510-K04-930	COVER, FR. CENTER .....	1	1		
7	64520-K04-930	COVER, FR. LOWER .....	1	1		
8	67100-K04-700ZA	VISOR SET, METER(WL) *TYPE1*.....	1	1		
9	67103-K04-700	RUBBER, VISOR .....	2	2		
10	90111-K04-930	BOLT, SCREEN STAY .....	4	4		
11	90116-SPO-003	CLIP, BUMPER SEAL .....	4	4		
12	90302-GGE-900	NUT, SPRING(M5) .....	4	4		
13	90302-KWW-A00	NUT, SPRING, 4MM .....	17	17		
14	90501-K04-930	WASHER, SCREEN SETTING(A) ...	4	4		

3