

I 10

F-14

Frame body • Wire harness

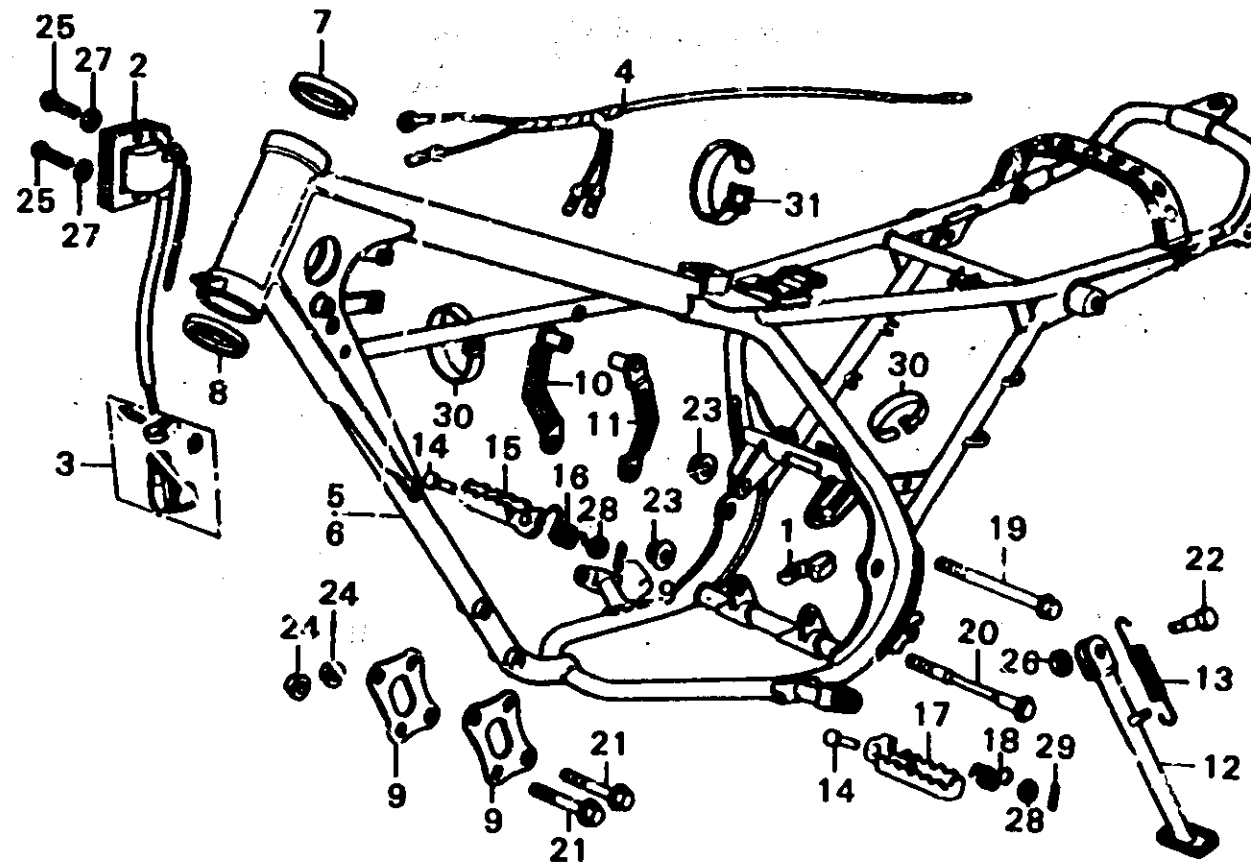

B381-47

Service item	F.R.T.	Ref. No.	Part No.	Description	Reqd. No. CR250 M1M2	Serial No.	Area code
FRAME BODY COMP.	4.0	1	11205-360-000	CLAMPER, TUBE	1	1	
STEERING TOP BALL RACE	0.8	2	30500-381-000	COIL ASSY., IGNITION	1	1	
• One or all		3	30700-360-701	TERMINAL ASSY., HIGH TENSION	1	1	
WIRE HARNESS	0.3	4	32100-381-670	HARNESS, WIRE	1	1	
IGNITION COIL ASSY.	0.2	5	50100-381-7708	BODY COMP., FRAME	1		
• SIDE STAND BAR		6	50100-381-770ZA	BODY COMP., FRAME *R-23*		1	
STEP and its related parts	0.1	7	50501-200-315	RACE, STEERING TOP BALL	1	1	
• One or all		8	50301-268-305	RACE, STEERING TOP BALL	1	1	
		9	50351-381-000	BRACKET, ENGINE HANGER	2	2	
		10	50361-381-303	STIFFENER, R. CENTER CROSS PIPE	1		
		11	50362-381-303	STIFFENER, L. CENTER CROSS PIPE	1		
		12	50530-381-000	BAR, SIDE STAND	1	1	
		13	50542-310-010	SPRING, SIDE STAND	1	1	
		14	50603-056-000	PIN, STEP BAR JOINT	2	2	
		15	50616-357-000	STEP COMP., R.	1	1	
		16	50617-329-000	SPRING, A. STEP RETURN	1	1	
		17	50642-357-000	STEP COMP., L.	1	1	
		18	50644-329-000	SPRING, L. STEP RETURN	1	1	
		19	90102-358-000	BOLT, HEX., 10MM	1	2	
		20	90102-381-303	BOLT, HEX., 10MM	1		
		21	90103-357-000	BOLT, HEX., 8MM	4	4	
		22	90108-283-000	SCREW, SIDE STAND PIVOT	1	1	
		23	90308-357-000	NUT, HEX., 10MM	2	2	
		24	90309-357-000	NUT, HEX., 8MM	4	4	

1977.05.20