

F-7 Air Cleaner · Side Cover

D 5

F-7 Air Cleaner · Side Cover

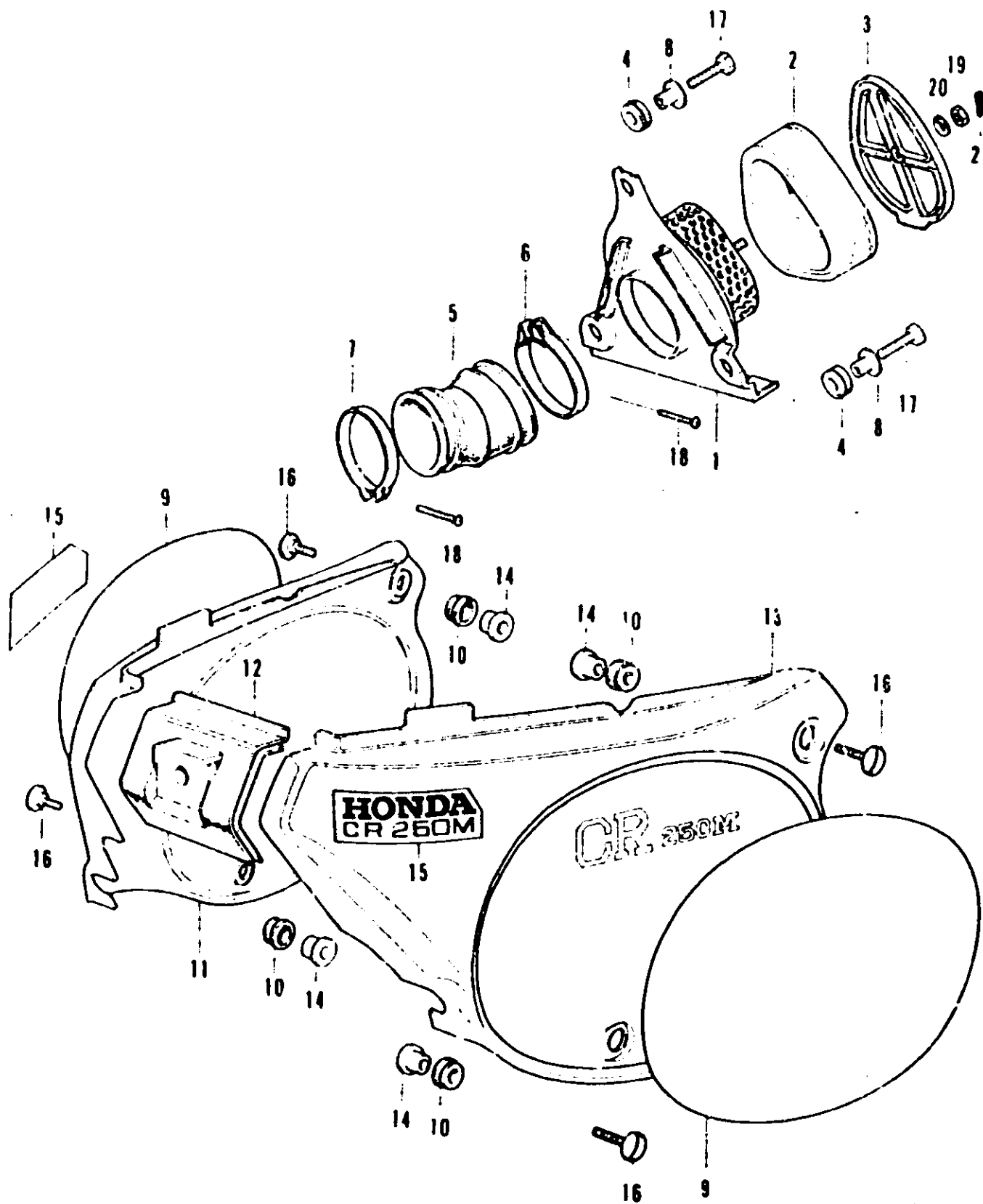

| Ref. No. | Part No.       | Description                       | Reqd. No. CR250M | Serial No. | Area Code |
|----------|----------------|-----------------------------------|------------------|------------|-----------|
| 1        | 17211-357-020  | BASE, AIR CLEANER                 | 1                |            |           |
| 2        | 17212-357-010  | ELEMENT, AIR CLEANER              | 1                |            |           |
| 3        | 17213-357-010  | HOLDER, AIR CLEANER ELEMENT       | 1                |            |           |
| 4        | 17245-107-010  | RUBBER, AIR CLEANER CASE MOUNTING | 2                |            |           |
| 5        | 17253-357-020  | TUBE, AIR CLEANER CONNECTING      | 1                |            |           |
| 6        | 17256-357-000  | BAND A, CLEANER CONNECTING TUBE   | 1                |            |           |
| 7        | 17257-357-000  | BAND B, CLEANER CONNECTING TUBE   | 1                |            |           |
| 8        | 61104-357-000  | COLLAR, FR. FENDER                | 3                |            |           |
| 9        | 61132-357-810  | PLATE A, NUMBER (YELLOW)          | 2                |            |           |
|          | 61133-357-810  | PLATE B, NUMBER (WHITE)           | 2                |            |           |
| 10       | 80105-061-000  | CUSHION A, RR. FENDER             | 4                |            |           |
| 11       | 83500-357-010  | COVER, R. SIDE                    | 1                |            |           |
| 12       | 83502-357-000  | RUBBER, SIDE COVER SETTING        | 1                |            |           |
| 13       | 83600-357-010  | COVER, L. SIDE                    | 1                |            |           |
| 14       | 83601-357-000  | COLLAR, COVER SET                 | 4                |            |           |
| 15       | 87204-357-670  | EMBLEM, SIDE COVER                | 2                |            |           |
| 16       | 90161-357-010  | SCREW, 6X12                       | 4                |            |           |
| 17       | 92000-06022    | BOLT, HEX., 6X22                  | 3                |            |           |
| 18       | 93500-04020-0A | SCREW, PAN, 4X20                  | 2                |            |           |
| 19       | 94001-06000    | NUT, HEX., 6MM                    | 1                |            |           |
| 20       | 94101-06000    | WASHER, PLAIN, 6MM                | 1                |            |           |
| 21       | 94251-06000    | PIN, LOCK, 6MM                    | 1                |            |           |

B357-12