

Block No.

F-23
Frame body

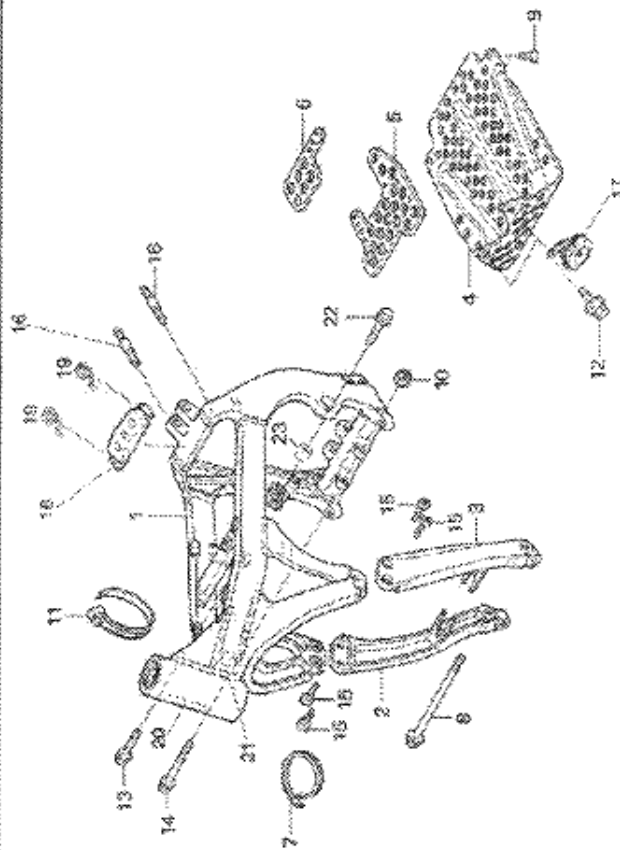

Ref.No.	Part No.	Description	Qty. '66	Ref.No.	Part No.	Description	Qty. '66
1	50100-NN4-810	FRAME BODY COMP.	1	16	92900-06022-0B	BOLT, STUD 2, 6X22	2
2	50310-NN4-600	TUBE R, DOWN	1	17	38116-KF1-620	HORN	1
3	50320-NN4-600	TUBE L, DOWN	1	18	80121-NN4-600	CUSHION RUBBER	1
4	50351-NN4-080	PLATE, SKID	1	19	61312-NN2-908	THE BAND	2
5	50352-NN4-080	RUBBER A, ENG CUSH.	1	20	87501-NN4-608	PLATE, FRAME NUMBER	1
6	50353-NN4-080	RUBBER B, ENG CUSH.	1	21	87615-MAG-660H1	MARK, CE.	1
7	61312-NN2-300	THE-BAND	2	22	50388-08018-80	BOLT, FLANGE DR 8X18	1
8	50119-MJ0-000	BOLT, FLANGE 10X130	1	23	50345-8N5-000	COLLAR UP ENG HANGER	1
9	50125-NN2-800	SCREW, FLANT 8X20	2				
10	50304-GA6-003	NUT, AXLE	1				
11	50650-NN3-000	CLAMPER	1				
12	93405-08020-00	BOLT-WASH, 8X20	2				
13	96303-08018-08	BOLT, FLANGE DR 8X18	1				
14	98400-10085-00	BOLT, FLANGE DR 10X85	1				
15	98700-08016-10	SOCKET BOLT, 8X16	4				