

E-19

GEARSHIFT DRUM

Ref. No.	L.O.N.	(Relative ref. Number)	Description	F.R.T.
1	210112	(2,3)	FORK, GEARSHIFT -INCLUDES: Engine removal and installation -NOTE: Same time for two units or more	5.1
5	2101A9		DRUM, GEARSHIFT -INCLUDES: Engine removal and installation	5.1
6	2101D6	(8)	PLATE, GEARSHIFT DRUM STOPPER	0.9
7	210125	(11)	STOPPER OR SPRING, SHIFT DRUM	0.9
9	210122		SPINDLE, GEARSHIFT	1.4
18	2101C3		BEARING, GEARSHIFT DRUM	5.3
19	1101F9		-INCLUDES: Engine removal and installation OIL SEAL, GEARSHIFT SPINDLE ..	1.4

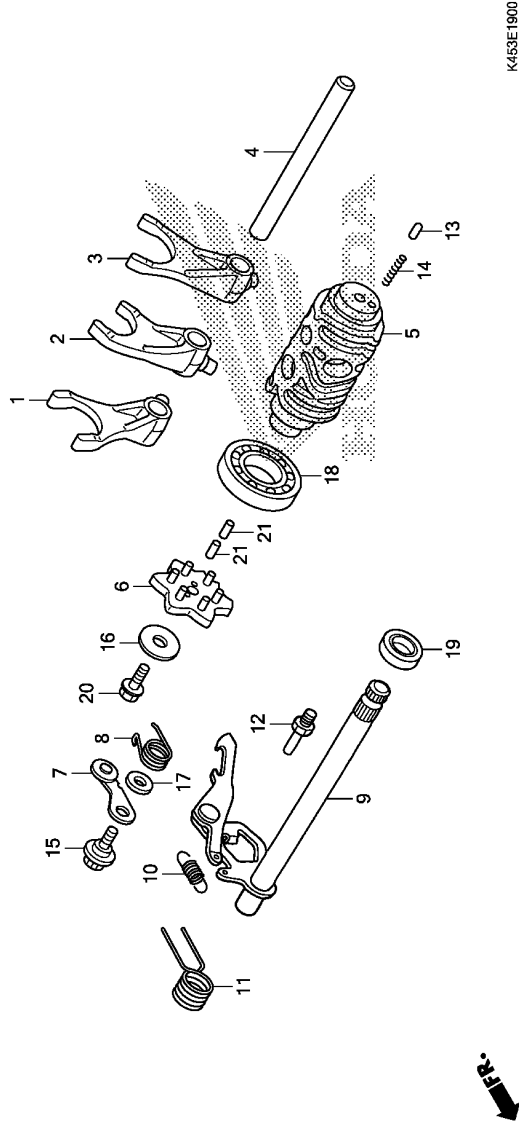

Ref. No.	Part No.	Description	Reqd. QTY		Serial No.	Parts catalogue code
			CBR	150R		
1	24211-K56-N00	FORK, R. GEARSHIFT	1			
2	24212-KPP-900	FORK, CENTER GEARSHIFT	1			
3	24213-K56-N00	FORK, L. GEARSHIFT	1			
4	24241-KPP-900	SHAFT, GEARSHIFT FORK	1			
5	24301-K45-N40	DRUM, GEARSHIFT	1			
6	24410-K45-N00	PLATE COMP., SHIFT DRUM STOPPER	1			
7	24430-K56-N00	STOPPER COMP., GEARSHIFT DRUM	1			
8	24436-K45-N40	SPRING, GEARSHIFT DRUM STOPPER	1			
9	24610-KPP-900	SPINDLE COMP., GEARSHIFT	1			
10	24641-KBP-900	SPRING, GEARSHIFT ARM	1			
11	24651-KTY-D30	SPRING, GEARSHIFT RETURN	1			
12	24652-035-000	PIN, SHIFT RETURN SPRING	1			
13	35751-KPH-900	CAP, CHANGE SWITCH CONTACT ..	1			
14	35752-KPH-900	SPRING, CHANGE SWITCH CONTACT	1			
15	90022-MG8-000	PIVOT, SHIFT DRUM STOPPER ARM	1			
16	90402-KW7-900	WASHER, THRUST, 6MM	1			
17	90435-HB3-000	WASHER, 6.1MM	1			
18	91009-K31-901	BEARING, RADIAL BALL, 6905	1			
	91015-K56-N01	BEARING, RADIAL BALL, 6905 (NSK)	1			
19	91209-KWC-901	OIL SEAL, 12X22X7	1			
20	95701-06016-00	BOLT, FLANGE, 6X16	1			
21	96220-30085	ROLLER, 3X8.5	2			