

E-3

CAMSHAFT/VALVE

Ref. No.	L.O.N.	(Relative ref. Number)	Description	F.R.T.
2	1111E5		CAMSHAFT :INTAKE -INCLUDES: Valve clearance adjustment	2.0
3	1111E6		CAMSHAFT :EXHAUST -INCLUDES: Valve clearance adjustment	2.0
	1111T4		CAMSHAFT :FOR 1 VEHICLE -INCLUDES: Valve clearance adjustment	2.1
4	1111K8		ARM, INTAKE VALVE ROCKER(ONE) -INCLUDES: Valve adjustment	1.9
5	1111K9		ARM, EXHAUST VALVE ROCKER(ONE) -INCLUDES: Valve adjustment	1.9
	1111L8		ARM, VALVE ROCKER :FOR 1 VEHICLE	1.9
7	1111N0		-INCLUDES: Valve adjustment VALVE, INTAKE(ONE)	2.9
8	1111N1		-INCLUDES: Refacing Replace all intake valve add VALVE, EXHAUST(ONE)	0.2 2.9
	1111N1A		-INCLUDES: Refacing Replace all exhaust valve add	0.2
	1111P0		VALVE :FOR 1 VEHICLE	3.5
			-INCLUDES: Refacing	

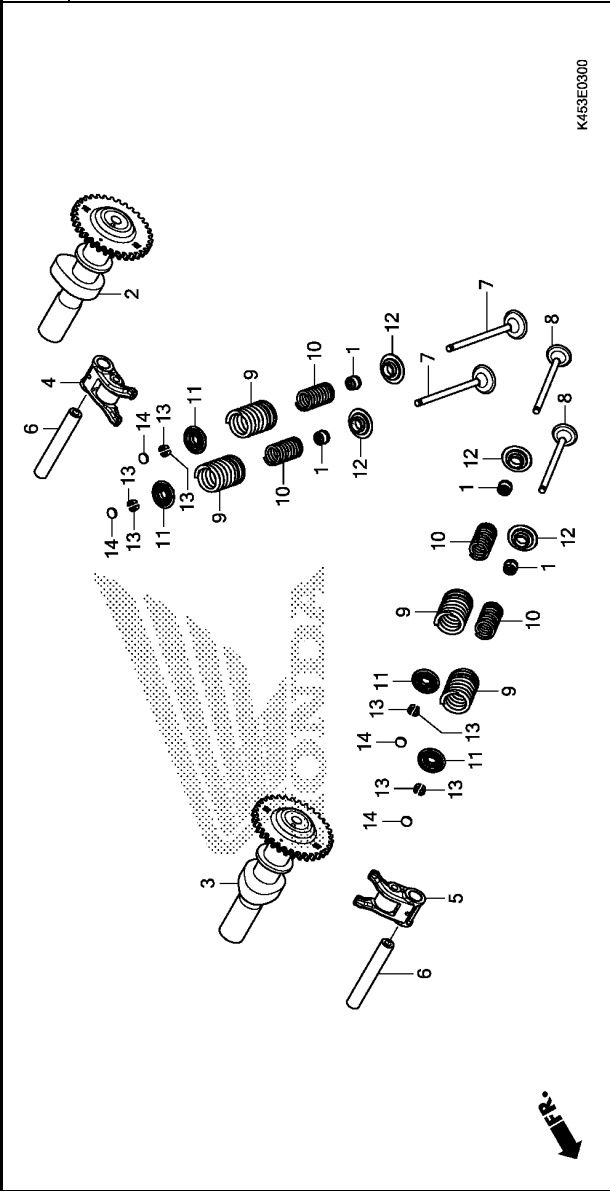

Ref. No.	Part No.	Description	Reqd. QTY		Serial No.	Parts catalogue code
			CBR	150R		
1	12209-K56-N01	SEAL, VALVE STEM(NOK)	4			
	12209-M10-722	SEAL, VALVE STEM(ARAI)	4			
2	14110-K56-N00	CAMSHAFT COMP., IN.	1			
3	14210-K56-N00	CAMSHAFT COMP., EX.	1			
4	14430-K56-N00	ARM COMP., IN. VALVE ROCKER ..	1			
5	14440-K56-N00	ARM COMP., EX. VALVE ROCKER ..	1			
6	14451-K56-N00	SHAFT, ROCKER ARM	2			
7	14711-K56-N00	VALVE, IN.	2			
8	14721-K56-N00	VALVE, EX.	2			
9	14751-K45-N41	SPRING, VALVE OUTER (PT. INDOSPRING TBK.)	4			
	14751-K56-N01	SPRING, VALVE OUTER (CHUU HATSUJ0)	4			
10	14761-K45-N41	SPRING, VALVE INNER (PT. INDOSPRING TBK.)	4			
	14761-K56-N01	SPRING, VALVE INNER (CHUU HATSUJ0)	4			
11	14771-MFL-000	RETAINER, VALVE SPRING	4			
12	14775-K56-N00	SEAT, VALVE SPRING	4			
13	14781-M10-720	COTTER, VALVE	8			
14	14913-KT7-013	SHIM, TAPPET(1.500)	4			
	14914-KT7-013	SHIM, TAPPET(1.525)	4			
	14915-KT7-013	SHIM, TAPPET(1.550)	4			
	14916-KT7-013	SHIM, TAPPET(1.575)	4			
	14917-KT7-013	SHIM, TAPPET(1.600)	4			
	14918-KT7-013	SHIM, TAPPET(1.625)	4			
	14919-KT7-013	SHIM, TAPPET(1.650)	4			