

|    |                      |                |
|----|----------------------|----------------|
| 1  | GUIDE, EX. VALVE     | 12023-205-000  |
| 2  | GUIDE, VALVE         | 12204-200-305  |
| 3  | CLIP, VALVE GUIDE    | 12253-200-300  |
| 4  | CVR, R. CYL HD SIDE  | 12331-202-000  |
| 5  | CVR, R. CYL HD SIDE  | 12331-205-020  |
| 6  | GASKET, R.           | 12394-200-000  |
| 7  | GEAR                 | 12431-205-000  |
| 8  | BUSH, TACH GR        | 12441-205-000  |
| 9  | GEAR                 | 14100-205-030  |
| 10 | CAMSHAFT             | 14101-206-000  |
| 11 | ARM, VALVE ROCKER    | 14431-200-000  |
| 11 | ARM, VALVE ROCKER    | 14431-206-000  |
| 12 | PIN                  | 14451-200-000  |
| 13 | COLLAR               | 14491-200-000  |
| 14 | VALVE, IN.           | 14711-200-020  |
| 15 | VALVE, EX.           | 14721-205-000  |
| 16 | SPRING, VALVE        | 14751-200-000  |
| 17 | SPRING, VALVE        | 14761-200-000  |
| 18 | RETAINER, VLV SPR    | 14771-011-000  |
| 19 | SEAT, VALVE SPRING   | 14775-200-000  |
| 20 | COTTER, VALVE        | 14781-001-010  |
| 21 | CAP ASSY.            | 30700-MG7-000  |
| 21 | CAP ASSY.            | 30700-243-610  |
| 21 | CAP ASSY.            | 30700-259-600  |
| 22 | TUBE                 | 32762-200-010  |
| 23 | SCREW, TAPPET ADJ.   | 90012-200-000  |
| 23 | SCREW, TAPPET ADJ.   | 90012-333-000  |
| 24 | BOLT, SEALING (12MM) | 90081-205-000  |
| 25 | NUT, TAPPET ADJ.     | 90206-001-000  |
| 26 | NUT, SEALING (20MM)  | 90241-205-000  |
| 27 | WASHER (12MM)        | 90451-205-000  |
| 28 | CIRCLIP (10MM)       | 90601-200-000  |
| 28 | CIRCLIP (10MM)       | 94510-10000    |
| 29 | SCREW, PAN (6X20)    | 93500-06020    |
| 29 | SCREW, PAN (6X20)    | 93500-06020-0A |
| 30 | SPARK PLUG (D9H)     | 98066-58710    |
| 30 | SPARK PLUG (D8HS)    | 98066-58714    |
| 30 | SPARK PLUG (D8HA)    | 98066-58717    |
| 30 | SPARK PLUG (D9H)     | 98066-58717-00 |
| 30 | SPARK PLUG (D10HS)   | 98066-60710    |
| 30 | SPARK PLUG (D10HS)   | 98066-60714    |

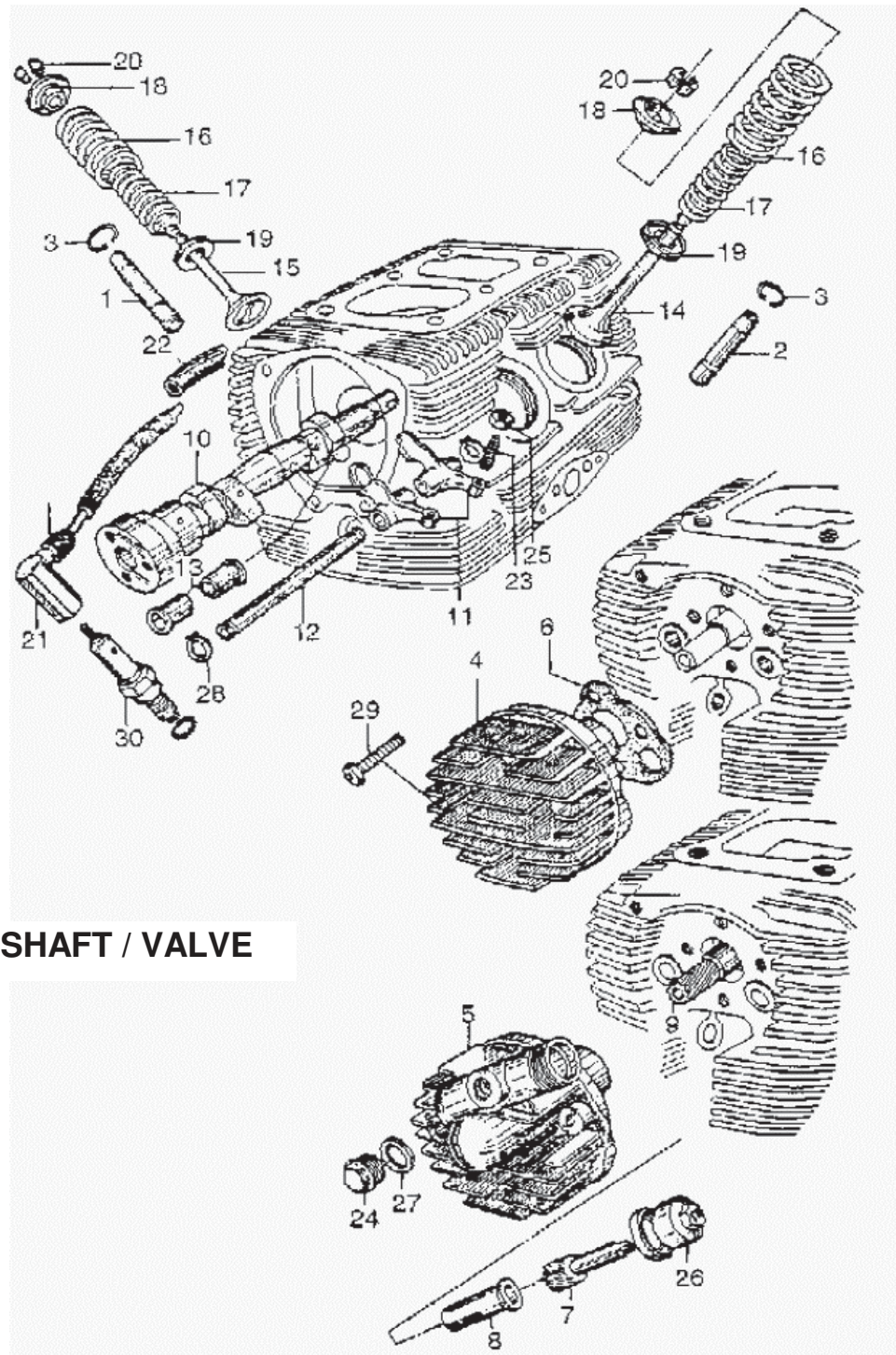

**CAMSHAFT / VALVE**