

Ref. No.	L.O.N.	(Relative ref. Number)	Description	F.R.T.
1	6161D5		TAILLIGHT UNIT	0.3
4	6161E2		BASE, TAILLIGHT	0.3
7	6161D8		LIGHT, LICENSE	0.3
10	6161F3	(8)	BULB, LICENSE LIGHT	0.1
11	6161G1	(3,5)	BULB, TAILLIGHT	0.1
16	4131K7		BRACKET, NUMBER PLATE	0.3

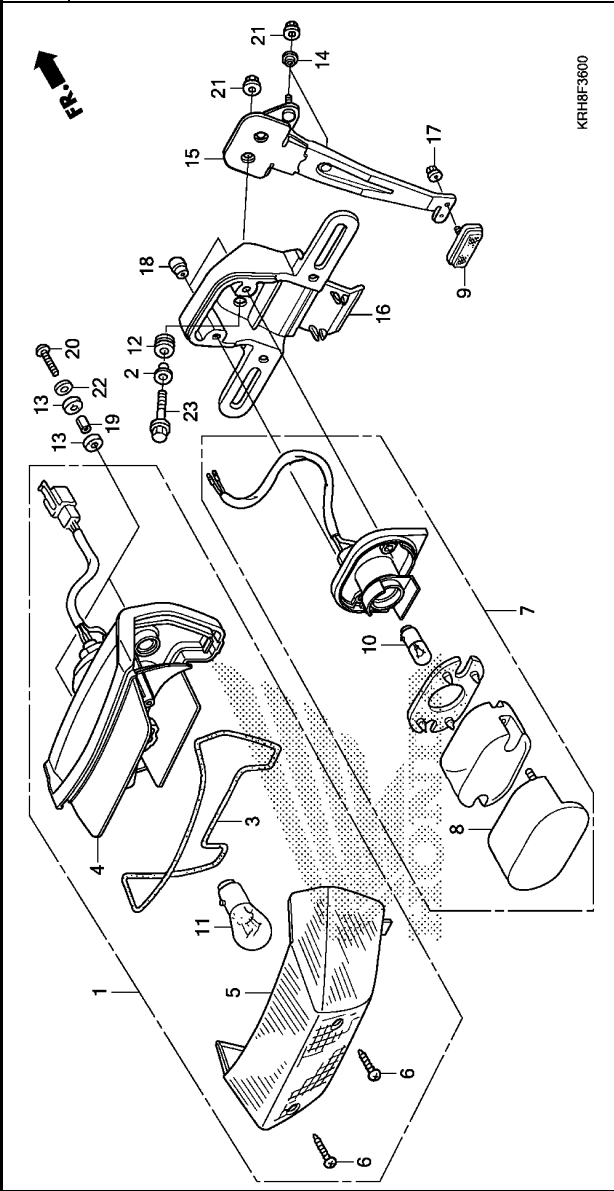

KRHBF3600

Ref. No.	Part No.	Description	Reqd. QTY	Serial No.	Parts catalogue code
			XR150		
			LEK		
			E		
1	33700-KRH-901	TAILLIGHT UNIT(12V 21/5W) ...	1		
2	33706-KRH-900	COLLAR, TAILLIGHT MOUNTING	2		
3	33708-KRH-901	PACKING, TAILLIGHT LENS	1		
4	33711-KRH-901	BASE COMP., TAILLIGHT	1		
5	33712-KRH-901	LENS COMP., TAILLIGHT	1		
6	33716-KRH-900	SCREW, TAPPING, 4X35	2		
7	33720-KRH-901	LIGHT ASSY., LICENSE(12V 5W)	1		
8	33723-KRH-901	COVER COMP., LICENSE	1		
9	33741-KRH-901	REFLECTOR, REFLEX	1		
10	34904-KRH-901	BULB, LICENSE(12V 5W)	1		
11	34906-447-711	BULB, TAIL & STOP LIGHT (12V 21/5W)(STANLEY)	1		
12	61103-357-000	RUBBER, FR. FENDER MOUNTING	2		
13	7218-KRH-900	RUBBER, SEAT HINGE	4		
14	80112-KRH-901	COLLAR, FENDER COVER	3		
15	84702-KRH-900	STAY, NUMBER BRACKET	1		
16	84703-KRH-900	BRACKET, NUMBER PLATE	1		
17	90301-GFM-890	NUT, SPECIAL, 5MM	1		
	90301-WG8-000	NUT, FLANGE, 5MM(FUSE RASHI)	1		
18	90302-WB2-000	NUT, SPECIAL, 4MM	2		
19	90504-KRH-900	COLLAR, TAILLIGHT MOUNTING	2		
20	93500-05020-0A	SCREW, PAN, 5X20	2		
21	94050-06000	NUT, FLANGE, 6MM	5		
22	94103-05000	WASHER, PLAIN, 5MM	2		
23	96001-06025-00	BOLT, FLANGE, 6X25	2		