

E-7-1

OIL PUMP(GLH125SH)

G 1

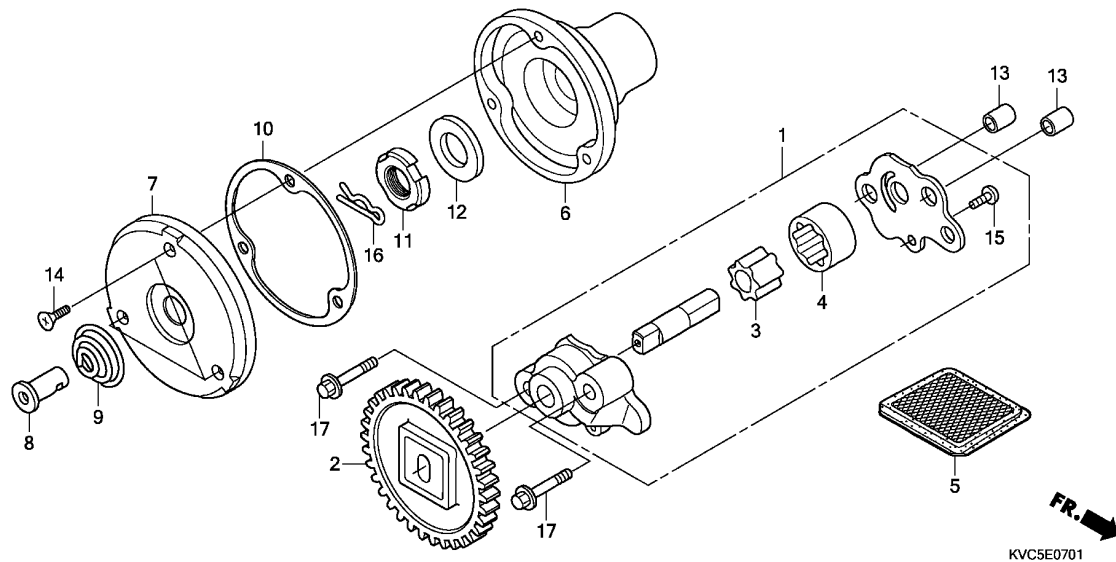

Ref. No.	L.O.N.	(Relative ref. Number) Description	F.R.T.
1	113105	PUMP ASSY., OIL .....	0.4
2	1131B8	GEAR, OIL PUMP DRIVE .....	0.3
3		(4)	
	1131C7	ROTOR, OIL PUMP .....	0.4
5	1131B5	SCREEN, OIL FILTER .....	0.3
6	1101L0	ROTOR, OIL FILTER .....	0.5
7		(10)	
	1101L1	CAP, OIL FILTER ROTOR .....	0.4

Ref. No.	Part No.	Description	Reqd. QTY				Serial No.	Parts catalogue code
			GLH125					
			1/2SH	1/2/3SH	1/2SH	SH		
			7	8	A	C		
1	15100-KVX-600	PUMP ASSY., OIL .....	-	-	-	1		
2	15130-KTT-900	GEAR COMP., OIL PUMP(34T) .....	-	-	-	1		
3	15331-KTE-910	ROTOR, OIL PUMP INNER .....	-	-	-	1		
4	15332-KTE-910	ROTOR, OIL PUMP OUTER .....	-	-	-	1		
5	15421-KSP-910	SCREEN, OIL FILTER .....	-	-	-	1		
6	15430-KSP-910	ROTOR, OIL FILTER .....	-	-	-	1		
7	15436-KRM-840	CAP, OIL FILTER ROTOR .....	-	-	-	1		
8	15441-KCS-650	THROUGH, OIL .....	-	-	-	1		
9	15446-107-000	SPRING, OIL THROUGH .....	-	-	-	1		
10	15459-KWK-900	GASKET, OIL FILTER CAP .....	-	-	-	1		
11	90231-KRM-840	NUT, LOCK, 14MM .....	-	-	-	1		
12	90432-KPT-A00	WASHER, 14.2X26X3 .....	-	-	-	1		
13	90702-KRM-840	DOWEL PIN, 8X14 .....	-	-	-	2		
14	93700-05012-0A	SCREW, OVAL, 5X12 .....	-	-	-	3		
15	93901-34120	SCREW, TAPPING, 4X8 .....	-	-	-	1		
16	94251-08000	PIN, LOCK, 8MM .....	-	-	-	1		
17	95701-06035-00	BOLT, FLANGE, 6X35 .....	-	-	-	2		