

F-3 Headlight

J 3

F-3 Headlight

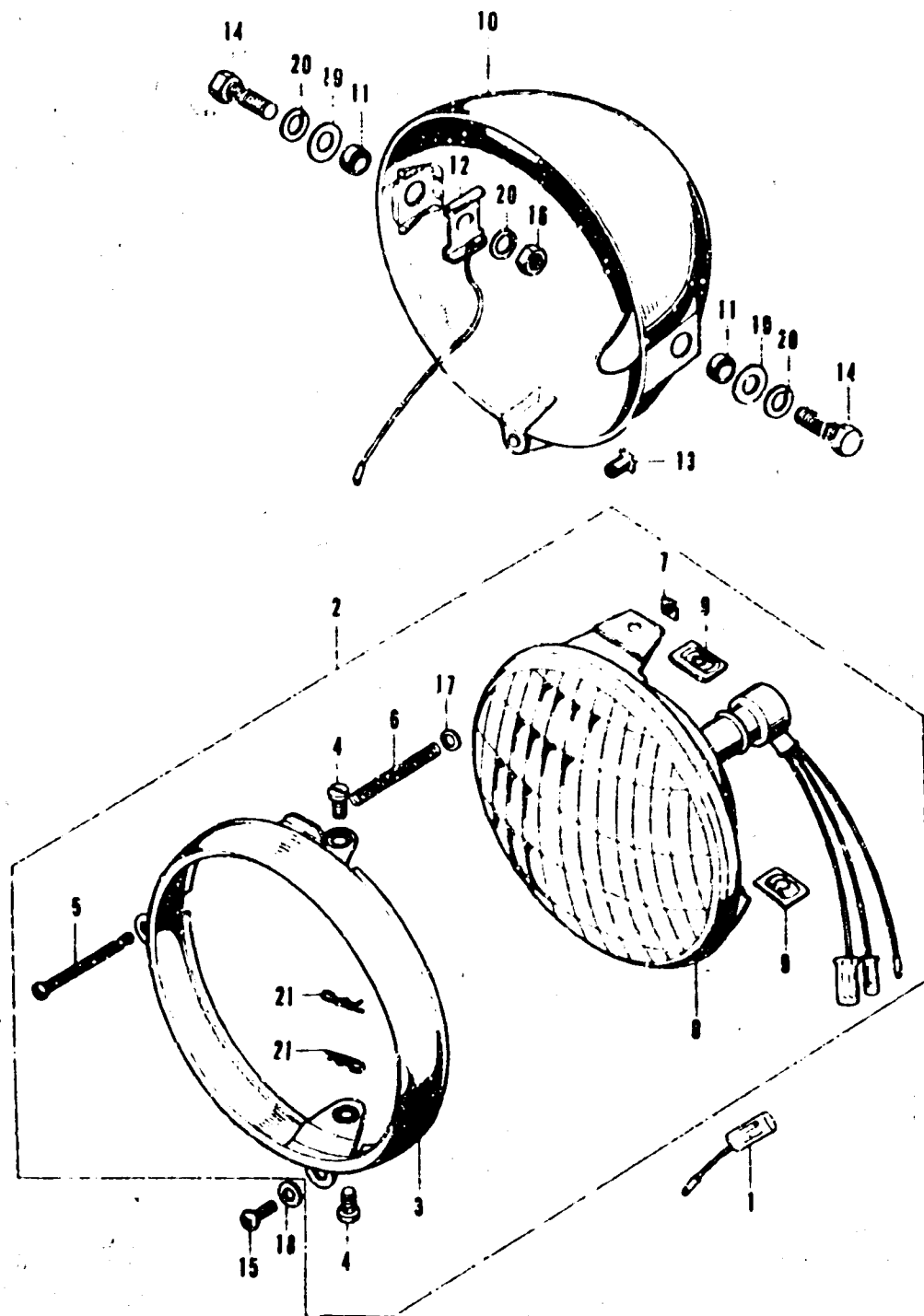

Ref. No.	Part No.	Description	Req. No. CL CL 1255/2551	Serial No.
1	32102-107-000	SUB CORD, WINKER	1 1	
2	33100-213-670	HEADLIGHT ASSY. (6V35/25W) (STANLEY)	1 1	
3	33101-243-670	RING HEADLIGHT	1 1	
4	33102-283-000	SCREW, UNIT HOLDER	2 2	
5	33103-200-020	SCREW, HEADLIGHT BEAM ADJUSTING	1 1	
6	33107-200-023	SPRING, HEADLIGHT BEAM ADJUSTING (STANLEY)	1 1	
7	33117-200-023	NUT, HEADLIGHT BEAM ADJUSTING	1 1	
8	33120-243-670	UNIT, HEADLIGHT (6V35/25W)	1 1	
9	33128-200-033	NUT, UNIT HOLDER	2 2	
10	61301-105-0008	CASE, HEADLIGHT	1 1	
11	61302-229-300	COLLAR, HEADLIGHT CASE	2 2	
12	61303-074-000	WASHER, HEADLIGHT CASE	2 2	
13	61308-229-310	NUT, HEADLIGHT SETTING	1 1	
14	92000-08025-08	BOLT, HEX., 8X25	2 2	
15	93500-05012-0A	SCREW, PAN, 5X12	1 1	
16	94001-38000-25	NUT, HEX., 8MM	2 2	
17	94101-04000	WASHER, PLAIN, 4MM	1 1	
18	94101-05000	WASHER, PLAIN, 5MM	1 1	
19	94101-08000	WASHER, PLAIN, 8MM	2 2	
20	94111-08000	WASHER, SPRING, 8MM	4 4	
21	94251-05000	PIN, LOCK, 5MM	2 2	