

C 4

E-2

Contact breaker · Advancer

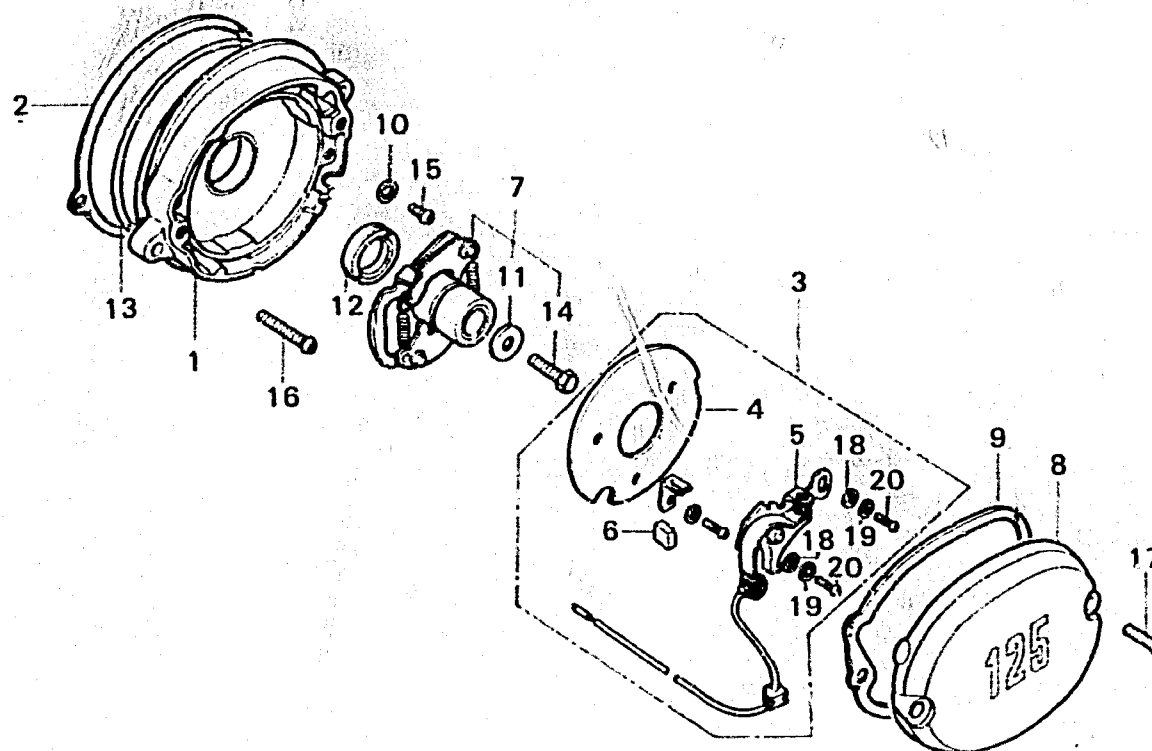

B383-2

Service item	F.R.T.	Ref. No.	Part No.	Description	Reqd. No. CB125S2	Serial No.	Area code
CONTACT BREAKER BASE/15X25X7		1	12332-324-000	BASE, CONTACT BREAKER	1		
OIL SEAL	0.5	2	12339-383-000	PACKING, CONTACT BREAKER BASE	1		
CONTACT BREAKER/BASE PLATE	0.4	3	30200-107-014	BREAKER ASSY., CONTACT (ND)	1	2058538	
CONTACT BREAKER ASSY./	0.3		30200-107-154	BREAKER ASSY., CONTACT (TOYO)	1	2058538	
SPARK ADVANCER ASSY.			30200-384-154	BREAKER ASSY., CONTACT (TOYO)	1	2058539	
CONTACT BREAKER COVER	0.1	4	30201-107-004	PLATE, CONTACT BREAKER BASE	1	2058538	
● OIL FELT			30201-107-154	PLATE, CONTACT BREAKER BASE (ND) (TOYO)	1		
		5	30202-107-004	BREAKER, CONTACT (ND)	1	2058538	
			30202-107-154	BREAKER, CONTACT (TOYO)	1		
		6	30205-028-004	FELT, OIL (ND)	1	2058538	
			30205-300-154	FELT, OIL (TOYO)	1		
		7	30220-107-004	ADVANCER ASSY., SPARK (ND)	1	2058538	
			30220-107-154	ADVANCER ASSY., SPARK (TOYO)	1	2058538	
			30220-384-154	ADVANCER ASSY., SPARK (TOYO)	1	2058539	
		8	30370-324-000	COVER, CONTACT BREAKER	1		
		9	30372-107-000	GASKET, CONTACT BREAKER COVER	1		
		10	90482-028-000	WASHER, 5MM	2		
		11	90486-028-000	WASHER, SPARK ADVANCER SETTING	1		
		12	91202-107-003	OIL SEAL, 15X25X7	1		
		13	91301-107-000	O-RING, 75X2.5	1		
		14	92000-06014	BOLT, HEX., 6X14	1		
		15	93500-05012-0A	SCREW, PAN, 5X12	2		
		16	93500-06025	SCREW, PAN, 6X25	2		
		17	93700-05020-0B	SCREW, OVAL, 5X20	2		
		18	94101-04000	WASHER, PLAIN, 4MM	2		

1979.03.01

C4