

E-8 Crankshaft - Piston

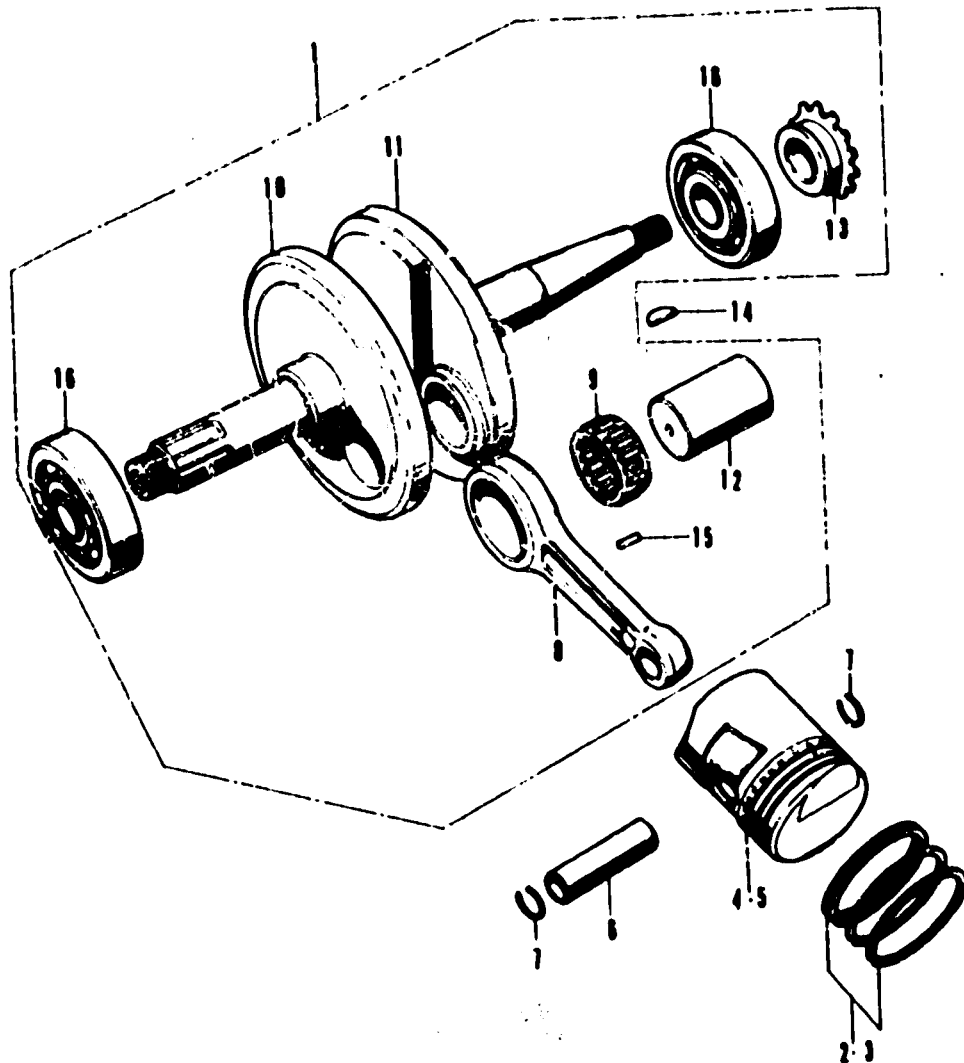

E-8 Crankshaft - Piston



Ref. No.	Part No	Description	Reqd. No.				Serial No.	Area code
			50	K2	70	K2		
1	13000-036-040	CRANKSHAFT ASSY.	1	1				
	13000-087-000	CRANKSHAFT COMP.			1	1		
2	13010-036-000	RING SET, PISTON (STD.)	1	1				
	13020-036-000	RING SET, PISTON (0.25)	(1)	(1)				
	13030-036-000	RING SET, PISTON (0.50)	(1)	(1)				
	13040-036-000	RING SET, PISTON (0.75)	(1)	(1)				
	13050-036-000	RING SET, PISTON (1.00)	(1)	(1)				
3	13010-087-003	RING SET, PISTON (STD. NIPPON)			1	1	D,E F,U	
	13020-087-003	RING SET, PISTON (0.25 NIPPON)			(1)	(1)	D,E F,U	
	13030-087-003	RING SET, PISTON (0.50 NIPPON)			(1)	(1)	D,E F,U	
	13040-087-003	RING SET, PISTON (0.75 NIPPON)			(1)	(1)	D,E F,U	
	13050-087-003	RING SET, PISTON (1.00 NIPPON)			(1)	(1)	D,E F,U	
4	13101-087-013	RING SET, PISTON (STD. NIPPON)				1	F,U	
	13020-087-013	RING SET, PISTON (0.25 NIPPON)				(1)	F,U	
	13030-087-013	RING SET, PISTON (0.50 NIPPON)				(1)	F,U	
	13040-087-013	RING SET, PISTON (0.75 NIPPON)				(1)	F,U	
	13050-087-013	RING SET, PISTON (1.00 NIPPON)				(1)	F,U	
5	13101-036-010	PISTON (STD.)	1	1				
	13102-036-010	PISTON (0.25)	(1)	(1)				
	13103-036-010	PISTON (0.50)	(1)	(1)				
	13104-036-010	PISTON (0.75)	(1)	(1)				
	13105-036-010	PISTON (1.00)	(1)	(1)				
6	13101-087-000	PISTON (STD.)			1	1	D,E F,U	
	13102-087-000	PISTON (0.25)			(1)	(1)	D,E F,U	
	13103-087-000	PISTON (0.50)			(1)	(1)	D,E F,U	
	13104-087-000	PISTON (0.75)			(1)	(1)	D,E F,U	
	13105-087-000	PISTON (1.00)			(1)	(1)	D,E F,U	
7	13101-087-711	PISTON (STD.)				1	F,U	
	13102-087-711	PISTON (0.25)				(1)	F,U	
	13103-087-711	PISTON (0.50)				(1)	F,U	
	13104-087-711	PISTON (0.75)				(1)	F,U	
	13105-087-711	PISTON (1.00)				(1)	F,U	
6	13111-036-000	PIN, PISTON	1	1				
	13111-087-000	PIN, PISTON			1	1		
7	13115-001-000	CLIP, PISTON PIN	2	2	2	2		