

Rear Brake Lock

Be sure the rear brake lock is applied while starting and warming up the engine.

Locking

Squeeze the rear brake lever and pull the brake lock knob.

- ▶ The rear brake lock will not function if the rear brake is not adjusted properly.

➔ P.74

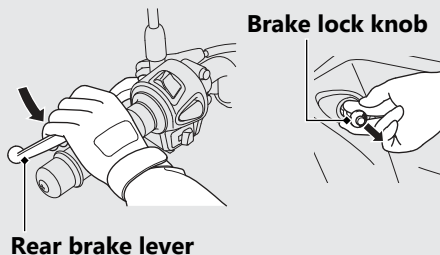

Unlocking

Squeeze the rear brake lever and press the brake lock knob down while pushing in the center button.

- ▶ Before riding, make sure that the rear brake lock is fully released so there is no drag on the rear wheel.

