

Inspecting the Rear Brake Pedal Freeplay

■ Pedal Height Adjustment

The stopper bolt is provided to allow adjustment of the pedal height.

1. Loosen the lock nut and turn the stopper bolt.
2. Tighten the lock nut.

■ Inspection

1. Place your motorcycle on a firm, level surface.
2. Measure the distance of the rear brake pedal before the starts to take hold.

Freeplay at the tip of the brake pedal: 13/16 to 1 3/16 in (20 to 30 mm)

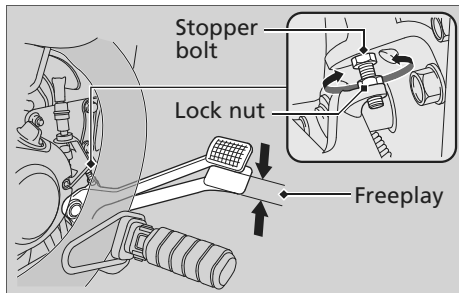

Make sure the brake rod, brake arm, spring and fastener are in good condition.