

Seat Removal

Refer to *Safety Precautions* on page 60 .

The seat must be removed to access the owner's manual and to maintain the battery.

Removal

1. Remove the seat mounting bolt A (1) and bolts B (2).
2. Pull the seat (3) back and up.

Installation

1. Insert the tab (4) into the frame cross member (5).
2. Tighten the seat mounting bolts securely.

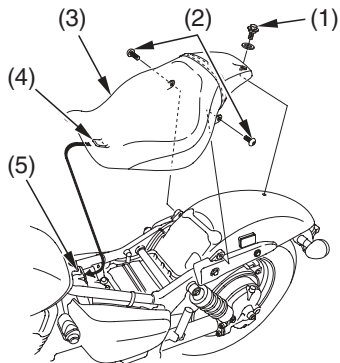

- (1) seat mounting bolt A
- (2) seat mounting bolts B
- (3) seat
- (4) tab
- (5) frame cross member