

# Storage Equipment

## Helmet Holder

Helmet holder is located on the left side below the seat.

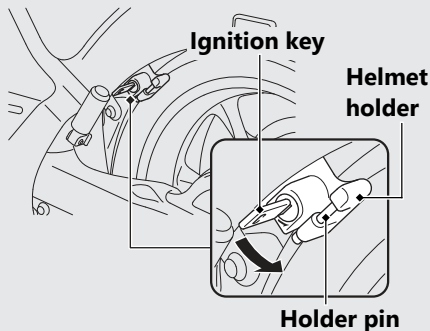

## Unlocking

Insert the ignition key and turn it counterclockwise.

## Locking

- 1 Hang your helmet on the holder pin and push it in to lock.
- 2 Remove the ignition key.
  - ▶ Use the helmet holder only when parked.

## **⚠ WARNING**

Riding with a helmet attached to the holder can interfere with the rear wheel or suspension and could cause a crash in which you can be seriously hurt or killed.

Use the helmet holder only while parked. Do not ride with a helmet secured by the holder.