

If You Have a Flat Tire

RIGHT REAR

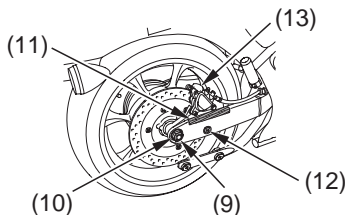

- | | |
|----------------------|------------------------------|
| (9) rear axle nut | (12) rear brake bracket bolt |
| (10) washer | (13) rear brake bracket |
| (11) protective tape | |

8. Cover the right swingarm with protective tape (11) or an equivalent.
9. Remove the rear brake bracket bolt (12).

10. Slide the rear axle shaft to the left side until the rear wheel can be removed. Do not pull the rear axle shaft out completely.
11. Remove the rear brake bracket (13).
12. Move the wheel to the right to separate it from the final drive gear case (14).
13. Remove the wheel and side collar.

- To avoid damage to the brake hose during removal, support the caliper assembly so that it doesn't hang from the hose. Do not twist the brake hose.
- Avoid getting grease, oil, or dirt on the disc or pad surfaces. Any contamination can cause poor brake performance or rapid pad wear after reassembly.