

Controls & Features

Accessory Socket

RIGHT FRONT

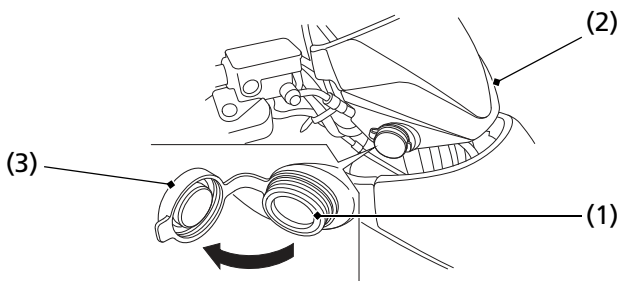

(1) accessory socket

(3) cap

(2) meter cover

The accessory socket (1) is attached to the right side of the meter cover (2). You can use the accessory socket to power a trouble light, CB radio, or cell phone, etc.

NOTICE

Do not plug in any heat-generating or high wattage accessory, such as an automobile cigarette lighter or high-power spotlight, because it can damage the socket.

To use the accessory socket, turn the ignition switch ON (I), start the engine. Then turn the headlights OFF (●), and open the accessory socket cap (3).