

Riding in Reverse

If you need to ride in reverse, make sure the area behind you is clear and only operate the ATV at low speed.

⚠ WARNING

Improperly operating in reverse could cause you to hit an obstacle or person behind you, resulting in serious injury.

Make sure there are no obstacles or people behind you before selecting reverse gear. When it is safe to proceed, go slowly.

1. Bring the vehicle to a complete stop with brakes, and holding the brakes.
2. Be sure there are no obstacles or people in the way.
3. Press and hold the reverse switch (2), then press the downshift switch (⇩) (1) within 10 seconds to shift into "R" reverse gear. You can also shift into "R" reverse gear by pressing and holding the downshift switch (⇩) (1), then pressing the reverse switch (2) within 0.5 seconds.
4. Make sure that the reverse indicator comes on and the gear position indicator shows "R".

LEFT HANDLEBAR

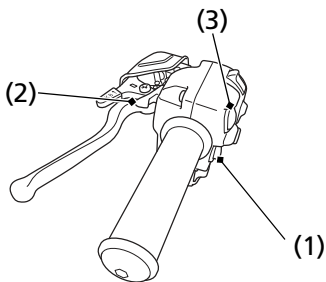

(1) downshift switch
(2) reverse switch

(3) upshift switch