

Controls & Features

Parking Brake/Reverse Lever (P/R Lever)

LEFT HANDLEBAR

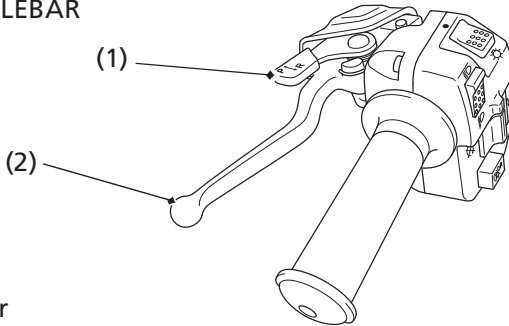

(1) P/R lever

(2) rear brake lever/parking brake lever

The P/R lever (1) on the rear brake lever/parking brake lever (2) is used to apply the parking brake or to shift the transmission into reverse.

To apply the parking brake:

Bring the vehicle to a complete stop, make sure the transmission is in neutral.

Squeeze the rear brake lever/parking brake lever (1), then rotate the P/R lever (2) clockwise until it engages the slot on the rear brake lever/parking brake lever bracket.

For information on *Parking*, see [page 103](#).

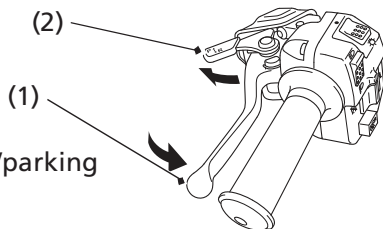

(1) rear brake lever/parking
brake lever

(2) P/R lever

(cont'd)