

# Gear Case Oil

1. Park your ATV on a firm, level surface.
2. Remove the skid plate bolts (1) and the skid plate (2).

## REAR UNDERSIDE

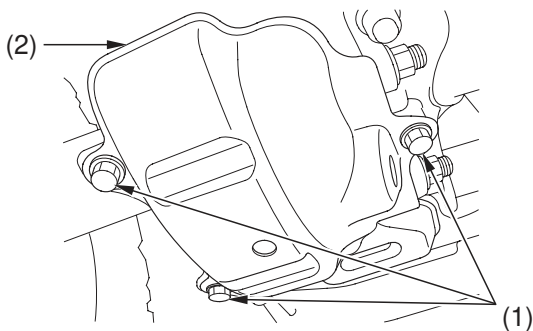

(1) skid plate bolts      (2) skid plate

3. Place an oil drain pan under the oil drain bolt (3).
4. Remove the oil fill cap (4) and the drain bolt.
5. After the oil has completely drained, reinstall the drain bolt with the new sealing washer and tighten it to the specified torque:  
**9 lbf·ft (12 N·m , 1.2 kgf·m)**
6. Remove the oil level check bolt (5).
7. Pour the drained oil into a suitable container and dispose of it in an approved manner (page 184).

### NOTICE

*Improper disposal of drained fluids is harmful to the environment.*

(cont'd)