

Engine Oil

Checking & Adding Oil

Refer to *Safety Precautions* on [page 81](#).

Check the engine oil level each day before operating your ATV and add if needed.

Before riding your ATV, check the engine oil level.

1. Park your ATV on a firm, level surface.
2. Start the engine in a well-ventilated area and let it idle for 3 – 5 minutes. Stop the engine and wait 2 – 3 minutes.
3. Remove the oil fill cap/dipstick (1) from the front crankcase cover and wipe it clean.
4. Insert the oil fill cap/dipstick without screwing it in, then remove the oil fill cap/dipstick and check the oil level. The oil level should be between the upper level mark (2) and the lower level mark (3) on the oil fill cap/dipstick.
5. If required, add the specified oil into the fill cap hole, up to the upper level mark on the oil fill cap/dipstick. Do not overfill.
6. Reinstall the oil fill cap/dipstick.

NOTICE

Running the engine with an improper oil level can cause serious engine damage.

LEFT SIDE

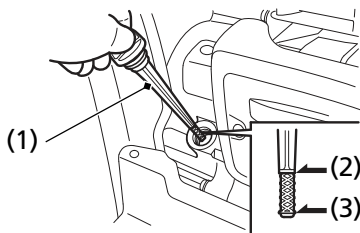

(1) oil fill cap/dipstick

(2) upper level mark

(3) lower level mark

(cont'd)