

- Slide the shroud (10) toward the down so that the shroud tab (11) and the slot (12) on the air cleaner housing cover (13) is aligned.
- Install the shroud D bolt (14), shroud C bolt (15), shroud B bolt (16) and shroud A bolt (17). Tighten the shroud A and B bolts to the specified torque:
7 lbf·ft (10 N·m, 1.0 kgf·m)
Tighten the shroud C and D bolt to the specified torque:
3.8 lbf·ft (5.2 N·m, 0.5 kgf·m)

The right and left shrouds can be installed in the same manner.

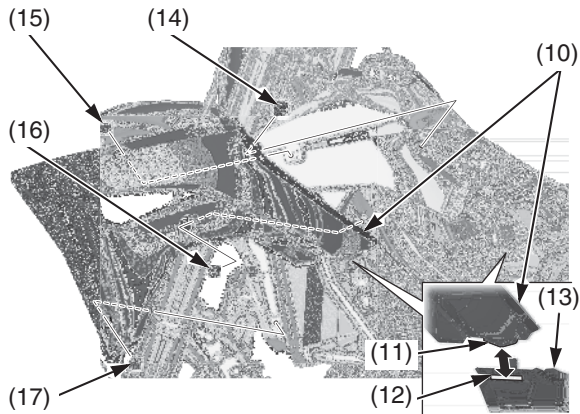

- | | |
|--------------------------------|--------------------|
| (10) shroud | (14) shroud D bolt |
| (11) tab | (15) shroud C bolt |
| (12) slot | (16) shroud B bolt |
| (13) air cleaner housing cover | (17) shroud A bolt |

- Install the seat (page 33).