

# Storage Equipment

Helmet holders, a helmet set wire (in the tool kit), a tool kit, and document bag are located under the rear seat.

There is also space to store a U-shaped lock.

## U-shaped lock

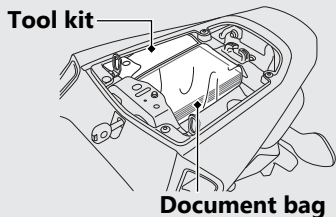
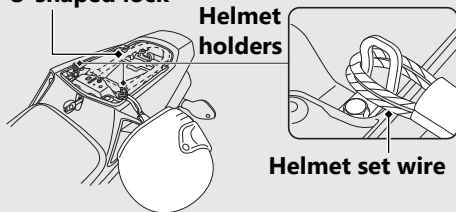

- ▶ U-shaped lock is not included with this motorcycle.
- ▶ The U-shaped lock is held in place above the rear fender.
- ▶ Use the helmet holder only when parked.
- ▶ Some U-shaped locks may not fit in the compartment due to their size or design.

## Removing the Rear Seat P.56

### **WARNING**

Riding with a helmet attached to the holder can interfere with the rear wheel or suspension and could cause a crash in which you can be seriously hurt or killed.

Use the helmet holder only while parked. Do not ride with a helmet secured by the holder.