

Remove the washers, bearing and clutch lifter cam.

Remove the ball retainer and clutch lifter with adjusting screw.

Check the disassembled parts for damage or wear, replace the parts if necessary.

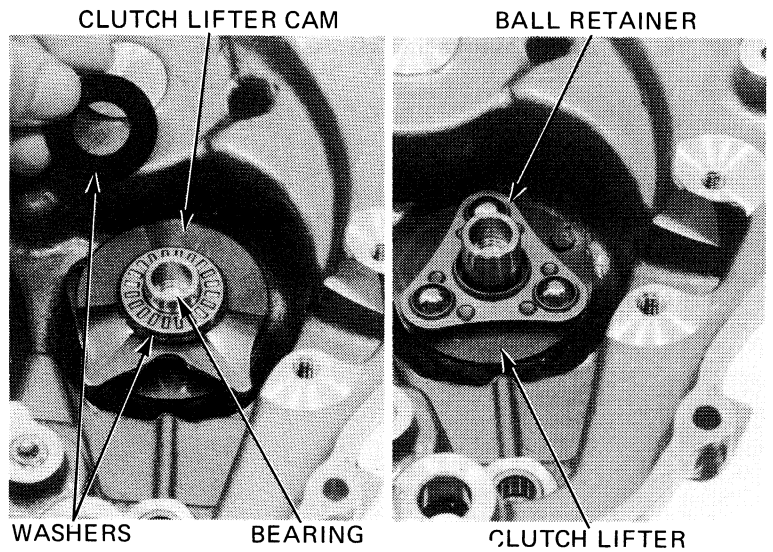

**CLUTCH LIFTER ASSEMBLY/
INSTALLATION**

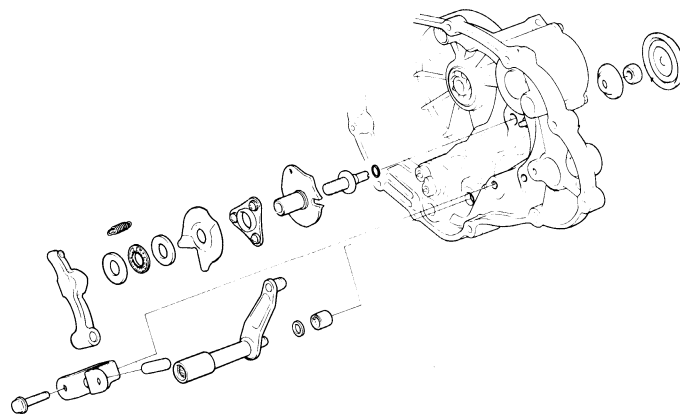

Install the adjusting screw into the clutch lifter cam.
Install the O-ring onto the adjusting screw.
Install the clutch lifter cam by aligning its groove with the stop pin on the right crankcase cover.

