

RIGHT CRANKCASE COVER REMOVAL

Drain the oil from the engine.

Remove the right crankcase cover bolts and cover.

Remove the gasket and dowel pins.

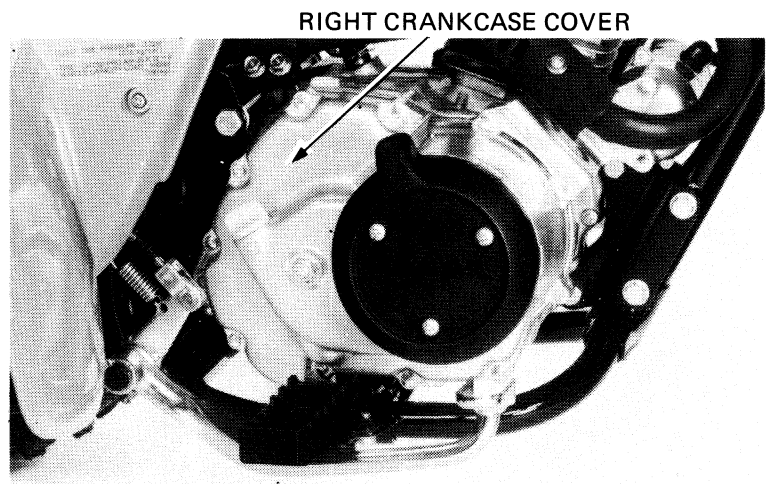

CLUTCH LIFTER LEVER DISASSEMBLY

Remove the clutch adjusting screw lock nut, washer and O-ring.

Remove the clutch lifter lever and spring.

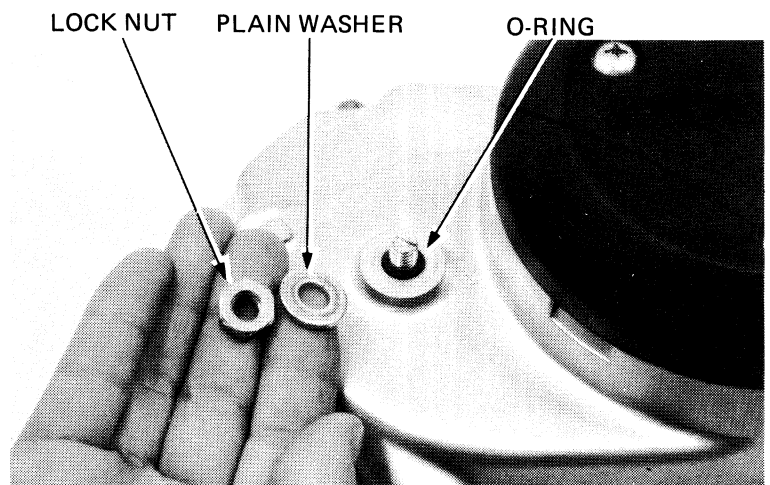

Remove the clutch adjusting screw.
Remove the circlip and disassemble the clutch lifter lever.

Check the disassembled parts for damage or wear, replace the parts if necessary.

