

### Spring preload adjustment:

To adjust preload, attach the 8 x 12 mm spanner (4) (see page 58) to the spring preload adjuster (1) as shown.

To reduce preload—turn the adjust knob in counterclockwise direction (2) toward LOW from the standard (STD) position.

To increase preload—turn the adjust knob in clockwise direction (3) toward HIGH.

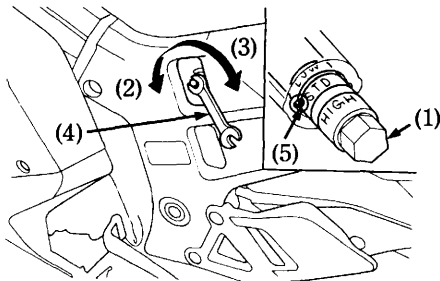

- |                      |                       |
|----------------------|-----------------------|
| (1) Adjuster         | (4) 8 x 12 mm Spanner |
| (2) Reduce preload   | (5) Mark              |
| (3) Increase preload |                       |

### ▲WARNING

- \* The rear shock absorber assembly includes a damper unit that contains high pressure nitrogen gas. The instructions found in this owner's manual are limited to adjustment of the shock assembly only. Do not attempt to disassemble, disconnect or service the damper unit; an explosion causing serious injury may result.
- \* Puncture or exposure to flame may also result in an explosion, causing serious injury.
- \* Service or disposal should only be done by your authorized Honda dealer or a qualified mechanic, equipped with the proper tools, safety equipment and the official Honda Shop Manual.