

Starting & Stopping the Engine

Always follow the proper starting procedure described below.

For your safety, avoid starting or operating the engine in an enclosed area such as a garage. Your ATV's exhaust contains poisonous carbon monoxide gas which can collect rapidly in an enclosed area and cause illness or death.

Preparation

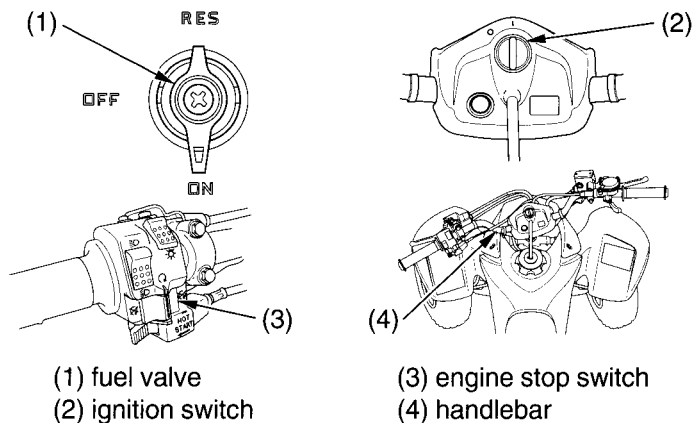

1. Before starting, select a level surface and lock the parking brake (page 23).
2. Turn the fuel valve (1) and ignition switch (2) to ON (|).
3. Turn the handlebar (4) all the way to left.

Confirm the following:

- The transmission is in NEUTRAL (the tires roll freely).
- The engine stop switch (3) is set to RUN (◯).

The high coolant temperature indicator should go off a few seconds after the engine starts.