

1. Grasp the starter grip ( 1 ) firmly, then pull it out slowly approximately 4 in (100 mm).
2. Pull the grip up briskly and fully.
3. After the engine starts, allow the starter grip to return slowly.

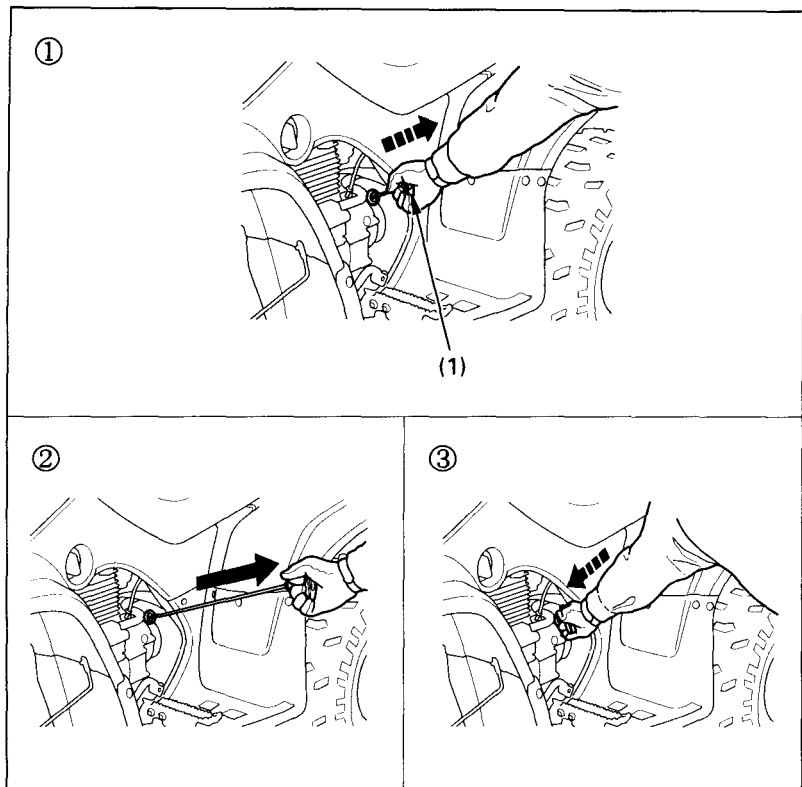

Fig. 2-9

(1) Recoil starter grip

Pull the recoil starter grip straight out so that the cord does not touch the side cover. Repeated contact with the side cover can damage the starter cord.