

## SEAT

To remove the seat (1), insert the ignition key into the seat lock (2) and turn it clockwise. Pull the seat back and up. To install the seat, insert the prong into the recess under the frame cross member and then push down on the rear of the seat.

### CAUTION:

- \* Be sure the seat is locked securely in position after installation.

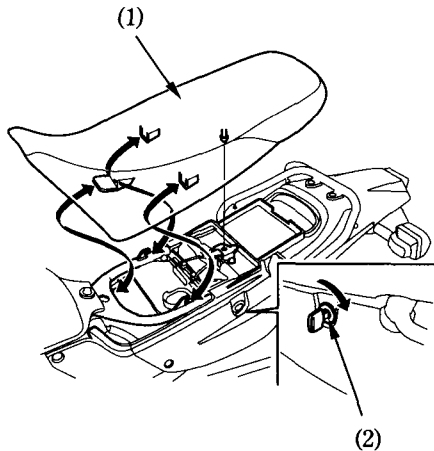

(1) Seat

(2) Seat lock