

Unlock the Ignition Switch For an Emergency

Set up:

1. Use the mechanical key to open the front seat (page 99) and remove the mat.
2. Remove the battery cover (page 171).
3. Pull out the blue connector (1) and release the tab while lifting the hook (2). Remove the blue dummy connector (3).
4. Connect the EM connector (4) in the tool kit to the connector.
5. Check the ID number (5) which is on the ID tag (6) or the inside of the Honda smart card key (7).

To check the ID number which is inside of the card key, see page 80 .

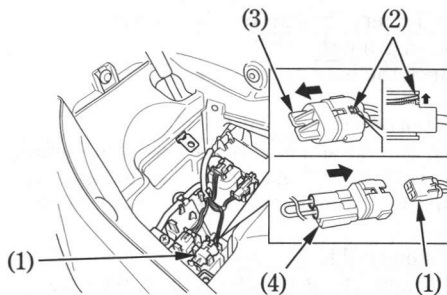

(1) Connector
(blue)

(2) Hook

(3) Dummy connector
(blue)

(4) EM connector

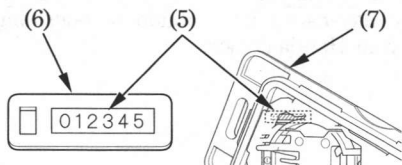

(5) ID number

(6) ID tag

(7) Honda smart card key