

- With your CRF on a box or an optional workstand (front wheel elevated), check that the steering moves smoothly from side-to-side.

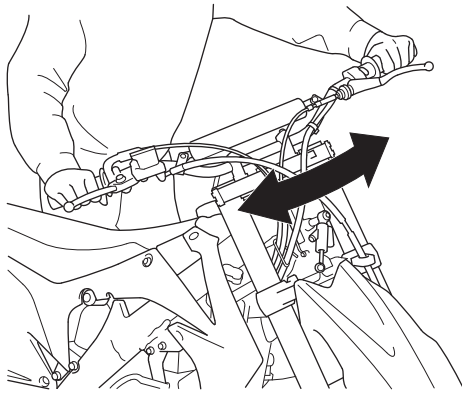

- Install the number plate (3) by aligning its holes (7) with the tabs (8) on the steering stem. Install and tighten the bolts (2). Route the number plate tab (1) around the handlebar pad (9) as shown.

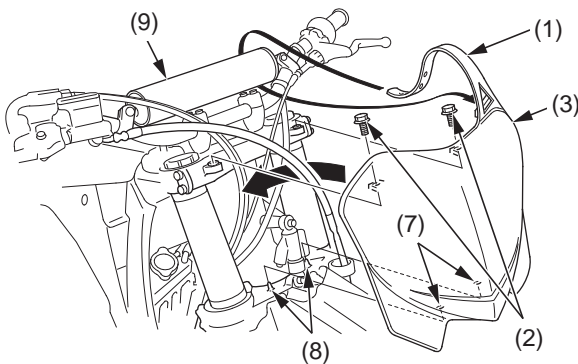

- |                      |                   |
|----------------------|-------------------|
| (1) number plate tab | (7) holes         |
| (2) bolts            | (8) tabs          |
| (3) number plate     | (9) handlebar pad |

## Removal

- Remove the number plate (page 108).
- Remove the steering damper mounting bolts (1), collar (2) and steering damper (3).

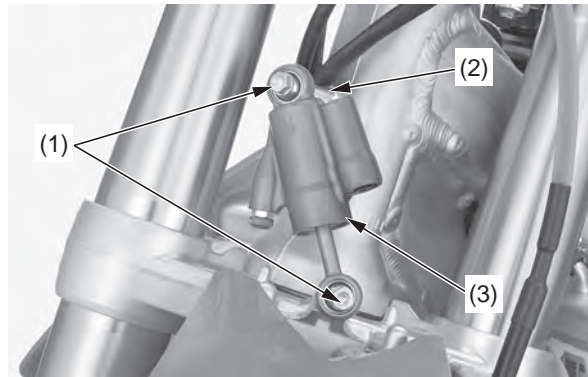

- |                                    |
|------------------------------------|
| (1) steering damper mounting bolts |
| (2) collar                         |
| (3) steering damper                |

## Inspection

- Check the damper rod (1) operation. Compress the fully extended damper rod by hand. Release the damper rod, then check that it extends to its maximum length.

If the damper rod does not extend to its maximum length, refer to an official Honda Shop Manual for disassembly and inspection instructions or see your Honda dealer.

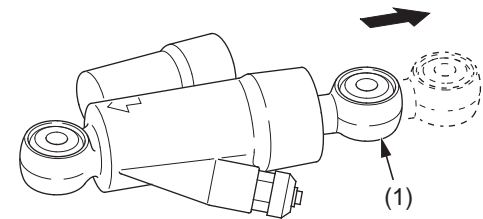

- |                |
|----------------|
| (1) damper rod |
|----------------|

(cont'd)