



3. Remove the oil filter bolts (3), oil filter cover (4) and oil filter (5).
4. Check that the oil filter cover O-ring (6) is in good condition and then install the new oil filter. Use the Honda oil filter or an equivalent filter specified for your model. Other filters not specified for your model may not filter impurities properly.
5. Install the filter with the rubber seal (7) facing out, away from the engine. You will see "OUT-SIDE" mark (8) on the filter body, near the seal.

**CAUTION:**

**\* Improper installation of the oil filter can cause serious engine damage.**

6. Reinstall the oil filter cover, making sure the bolts are tightened securely.  
Oil Filter Bolt Torque:  
12 N·m (1.2 kgf·m , 9 lbf·ft)

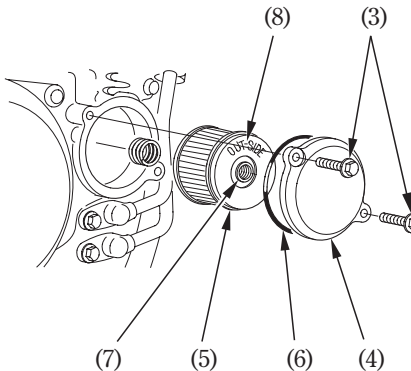

- |                      |                   |
|----------------------|-------------------|
| (3) Oil filter bolts | (6) O-ring        |
| (4) Oil filter cover | (7) Rubber seal   |
| (5) Oil filter       | (8) OUT-SIDE mark |

