

Headlight Bulb

1. Remove the screws from the headlight case.
2. Gently pull the lower end of the headlight forward and remove the headlight.
3. Disconnect the connector by pressing tabs.

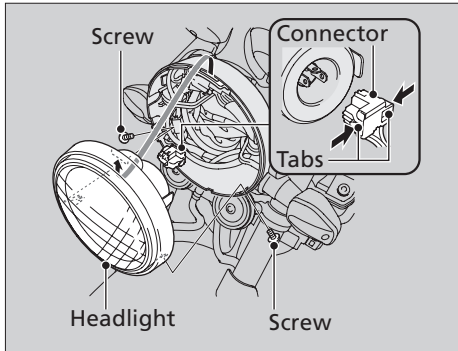

Electrical Trouble ► Burned-out Light Bulb

4. Remove the dust cover.
5. Unhook the pin and remove the bulb.
6. Install a new bulb in the reverse order of removal.
 - Install the dust cover with its "TOP" mark facing up.

Do not touch the glass surface of a new headlight bulb with your fingers. If you touch the bulb with your bare hands, clean it with a cloth moistened with alcohol.

