

FRONT HANDLE COVER

The front handle cover must be removed for headlight and position light bulb replacement.

Removal:

1. Pull up the dust covers (1).
2. Loosen the lock nuts (2) until they will no longer turn.
3. Remove the rearview mirrors (3).
4. Remove the front top cover (page 43).
5. Remove the screws A (4) and screws B (5).
6. Remove the bolt (6).
7. Remove the front handle cover (7), then disconnect the connectors (8).

Installation:

- Installation can be done in the reverse order of removal.
 - To install the rearview mirrors.
 1. Install the rearview mirrors until they will no longer turn.

2. Loosen the rearview mirrors approximately 2 turns.
3. Adjust the rearview mirrors.
4. Tighten the lock nuts and install the dust covers.

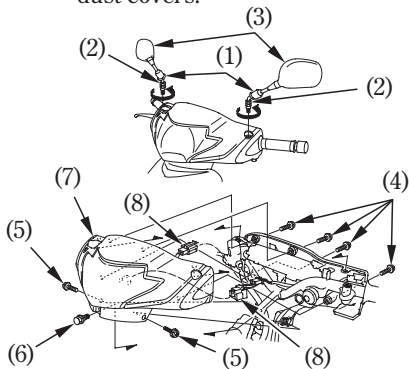

- | | |
|----------------------|------------------------|
| (1) Dust covers | (6) Bolt |
| (2) Lock nuts | (7) Front handle cover |
| (3) Rearview mirrors | (8) Connectors |
| (4) Screws A | |
| (5) Screws B | |